

2004 GENERAL MOTORS

Saturn Vue

BUZZERS, RELAYS & TIMERS

BUZZERS, RELAYS & TIMERS LOCATION

Component	Location
A/C CLUTCH Relay	In underhood fuse block. See Fig. 3 .
BACKUP LAMP Relay (V6)	In underhood fuse block. See Fig. 3 .
COOL FAN HI Relay (L4)	In underhood fuse block. See Fig. 3 .
COOL FAN LOW Relay (L4)	In underhood fuse block. See Fig. 3 .
COOL FAN 1 Relay (V6)	In underhood fuse block. See Fig. 3 .
COOL FAN 2 Relay (V6)	In underhood fuse block. See Fig. 3 .
Cooling Fan Relay 3 (3.5L)	At left front of engine compartment. See Fig. 23 .
DR LCK Relay	In I/P fuse block. See Fig. 4 .
DRL Relay	In underhood fuse block. See Fig. 3 .
DRV DR UNLCK Relay	In I/P fuse block. See Fig. 4 .
ENG MAIN Relay (L4)	In underhood fuse block. See Fig. 3 .
FOG LP Relay	In underhood fuse block. See Fig. 3 .
FRT WIPER Relay	In underhood fuse block. See Fig. 3 .
FUEL PUMP Relay	In underhood fuse block. See Fig. 3 .
HEAD LAMP Relay	In I/P fuse block. See Fig. 4 .
HORN Relay	In underhood fuse block. See Fig. 3 .
HVAC BLOWER Relay	In I/P fuse block. See Fig. 4 .
PARK LAMP Relay	In I/P fuse block. See Fig. 4 .
PASS DR UNLOCK Relay	In I/P fuse block. See Fig. 4 .
PWR WDW Relay	In underhood fuse block. See Fig. 3 .
REAR DEFOG Relay	In underhood fuse block. See Fig. 3 .
RR WIPER Relay	In underhood fuse block. See Fig. 3 .
Starter Relay Relay	At lower left front corner of engine compartment.
WIPER SYSTEM Relay	In underhood fuse block. See Fig. 3 .

CIRCUIT PROTECTION DEVICES

CIRCUIT PROTECTION DEVICES LOCATION

Component	Location
I/P Fuse Block	Behind center of dash. See Fig. 1 .
Underhood Fuse Block	Left side of engine compartment. See Fig. 1 .

CONTROL UNITS

CONTROL UNITS LOCATION

Component	Location
Body Control Module (BCM)	Below front of center floor console. See Fig. 34 .
Electronic Brake Control Module (EBCM)	Near left front shock tower. See Fig. 24 .
Engine Control Module (ECM) (2.2L)	On intake manifold, under ignition coil housing. See Fig. 34 .
Heated Seat Module - Driver	Under left front seat.
Heated Seat Module - Front Passenger	Under right front seat.
HVAC Module	At center of dash.
Ignition Control Modules (ICM) 1, 2 & 3	At top of engine, above corresponding cylinder. See Fig. 14 .
Ignition Control Modules (ICM) 4, 5 & 6	At top of engine, above corresponding cylinder. See Fig. 13 .
Inflatable Restraint I/P Module	Behind top right side of dash. See Fig. 6 .
Inflatable Restraint Roof Rail Module - Left	Behind headliner, above driver. See Fig. 6 .
Inflatable Restraint Roof Rail Module - Left Disable Connector	Behind headliner, above left rear window. See Fig. 6 .
Inflatable Restraint Roof Rail Module - Right	Behind headliner, above front passenger. See Fig. 6 .
Inflatable Restraint Roof Rail Module - Right Disable Connector	Behind headliner, above right rear window. See Fig. 6 .
Inflatable Restraint Sensing & Diagnostic Module (SDM)	Under rear of center console. See Fig. 6 .
Inflatable Restraint Steering Wheel Module	In center of steering wheel. See Fig. 6 .
Power Steering Control Module (PSCM)	On bottom of steering column. See Fig. 34 .
Powertrain Control Module (PCM)	In engine compartment, mounted near right strut tower.
Roof Rail Module - Left	At top of left "C" pillar. See Fig. 7 .
Roof Rail Module - Right	At top of right "C" pillar. See Fig. 7 .
Sensing & Diagnostic Module (SDM)	Under center floor console. See Fig. 7 .
Sunroof Control Module	At left front of sunroof module.
Throttle Actuator Control (TAC) Module (2.2L)	At left rear side of engine , on throttle body. See Fig. 19 .
Throttle Actuator Control (TAC) Module (3.5L)	At rear of engine , on throttle body. See Fig. 13 .
Transmission Control Module (TCM)	At left side of engine compartment. See Fig. 34 .
Vehicle Communication Interface Module (VCIM)	Under left side of dash. See Fig. 8 .

MOTORS

MOTORS LOCATION

Component	Location
Blower Motor	At right side of HVAC. See Fig. 26 .

Cooling Fan - Left (3.5L)	Behind left side of radiator. See Fig. 23 .
Cooling Fan - Right (3.5L)	Behind right side of radiator. See Fig. 23 .
Cooling Fan (2.2L)	Behind radiator. See Fig. 22 .
EPS Motor	Under left side of dash, on steering column.
Front Wiper Motor	Below left side of windshield. See Fig. 27 .
Fuel Pump & Sender Assembly - Primary	Inside left side of fuel tank.
Fuel Pump & Sender Assembly - Secondary	Inside right side of fuel tank.
HVAC Blower	On HVAC assembly.
Mode Actuator - Defrost	On left side of HVAC assembly. See Fig. 26 .
Mode Actuator - Floor	On left side of HVAC assembly. See Fig. 26 .
Ratio Control Motor (VT25-E)	At top rear of automatic transmission. See Fig. 18 .
Recirculation Actuator	On lower front of HVAC assembly. See Fig. 26 .
Seat Horizontal Motor - Driver	Under driver seat.
Seat Recline Motor - Driver	Under driver seat.
Seat Vertical Motor - Driver	Under driver seat.
Starter	At lower right rear of engine. See Fig. 21 .
Sun Roof Motor	At right front of sunroof module assembly.
Throttle Actuator Control Module	Integral to throttle body.
Window Motor - Driver	In left front door.
Window Motor - Front Passenger	In right front door.
Window Motor - LR	In left rear door.
Window Motor - RR	In right rear door.
Windshield Washer Fluid Pump	In washer fluid reservoir.
Windshield Wiper Motor	Under left side of cowl, integral to front wiper module assembly.
Wiper Motor - Rear	On liftgate, integral to rear wiper module assembly. See Fig. 32 .

SENDING UNITS & SENSORS

SENDING UNITS & SENSORS LOCATION

Component	Location
Accelerator Pedal Position (APP) Sensor	On accelerator pedal linkage arm.
A/C Refrigerant Pressure Sensor	In A/C high side pressure line.
Ambient Air Temperature Sensor	Behind front grille. See Fig. 28 .
Automatic Transmission Fluid Temperature Sensor, W/Harness (5AT)	At rear of automatic transmission. See Fig. 17 .
Automatic Transmission Input & Output Speed Sensor Assembly (VT25-E)	At top of automatic transmission. See Fig. 18 .
Camshaft Position (CMP) Sensor (3.5L)	On top left front of engine. See Fig. 14 .

Crankshaft Position (CKP) Sensor (2.2L)	On left side of engine block, above starter. See Fig. 20 .
Crankshaft Position (CKP) Sensor (3.5L)	At lower front of engine, near crankshaft. See Fig. 14 .
Engine Coolant Temperature (ECT) Sensor (2.2L)	On thermostat housing. See Fig. 20 .
Engine Coolant Temperature (ECT) Sensor (3.5L)	At rear of engine. See Fig. 13 .
Evaporator Temperature Sensor	In engine compartment, on expansion valve block.
Fuel Tank Pressure (FTP) Sensor	At top of primary fuel pump & sender assembly.
Heated Oxygen Sensor (HO2S) Bank 1 Sensor 1 (3.5L)	On right exhaust manifold. See Fig. 14 .
Heated Oxygen Sensor (HO2S) Bank 1 Sensor 2 (3.5L)	In exhaust system, downstream of right catalytic converter. See Fig. 14 .
Heated Oxygen Sensor (HO2S) Bank 2 Sensor 1 (3.5L)	On left exhaust manifold. See Fig. 13 .
Heated Oxygen Sensor (HO2S) Bank 2 Sensor 2 (3.5L)	In exhaust system, downstream of left catalytic converter. See Fig. 13 .
Heated Oxygen Sensor (HO2S) Sensor 1 (2.2L)	On right rear of engine, in exhaust manifold. See Fig. 20 .
Heated Oxygen Sensor (HO2S) Sensor 2 (2.2L)	In exhaust manifold, behind catalytic converter.
Inflatable Restraint Side Impact Sensor (SIS) - Left	On lower left "B" pillar. See Fig. 6 .
Inflatable Restraint Side Impact Sensor (SIS) - Right	On lower right "B" pillar. See Fig. 6 .
Input Speed Sensor (5AT)	In automatic transmission. See Fig. 17 .
Intake Air Temperature (IAT) Sensor 1 (3.5L)	At right side of engine compartment, on lower left side of air cleaner housing.
Intake Air Temperature (IAT) Sensor (2.2L)	In engine compartment, in air cleaner duct.
Intake Air Temperature (IAT) Sensor 2 (3.5L)	On left side of engine, attached to front of intake manifold. See Fig. 13 .
Knock Sensor (KS) (2.2L)	On left side of engine block, near starter. See Fig. 20 .
Knock Sensor (KS) (3.5L)	At top center of engine, beneath intake manifold. See Fig. 13 .
Manifold Absolute Pressure (MAP) Sensor (2.2L)	On intake manifold. See Fig. 20 .
Manifold Absolute Pressure (MAP) Sensor (3.5L)	On intake manifold. See Fig. 13 .
Mass Airflow Sensor	Between air box & throttle body.
Output Speed Sensor (5AT)	In automatic transmission. See Fig. 17 .
Passlock Sensor	At top of steering column. See Fig. 34 .
Primary Fuel Pump Module	On right side of fuel tank.
Secondary Fuel Pump Module	On left side of fuel tank.
Side Impact Sensor (SIS) & Seat Belt Pretensioner-LF	At base of left "B" pillar. See Fig. 7 .
Side Impact Sensor (SIS) & Seat Belt Pretensioner-RF	At base of right "B" pillar. See Fig. 7 .

Steering Shaft Torque Sensor	On steering column.
Transmission Fluid Pressure Sensor (VT25-E)	At top front of automatic transmission. See Fig. 18 .
Vehicle Speed Sensor (VSS) (M/T)	At rear of transmission. See Fig. 15 .
Wheel Speed Sensor (WSS) - LF	On left front wheel steering knuckle. See Fig. 24 .
Wheel Speed Sensor (WSS) - LR	On left rear wheel hub. See Fig. 24 .
Wheel Speed Sensor (WSS) - RF	On right front wheel steering knuckle. See Fig. 24 .
Wheel Speed Sensor (WSS) - RR	On right rear wheel hub. See Fig. 24 .

SOLENOIDS & SOLENOID VALVES

SOLENOIDS & SOLENOID VALVES LOCATION

Component	Location
A/C Compressor Clutch (2.2L)	At lower left front of engine. See Fig. 20 .
A/C Compressor Clutch (3.5L)	At right front of engine.
A/T Shift Lock Solenoid	In front center console, at base of shifter assembly. See Fig. 16 .
Automatic Transmission Clutch Pressure Control "A" (1) Solenoid (5AT)	In automatic transmission assembly. See Fig. 17 .
Automatic Transmission Clutch Pressure Control "B" (2) Solenoid (5AT)	In automatic transmission. See Fig. 17 .
Brake Pressure Modulator Valve (BPMV)	At left rear corner of engine compartment, below brake master cylinder.
Door Lock Actuator - Driver	Inside left front door.
Door Lock Actuator - Front Passenger	Inside right front door.
Door Lock Actuator - LR	Inside left rear door.
Door Lock Actuator - RR	Inside right rear door.
Evaporative Emissions (EVAP) Canister Purge Solenoid (2.2L)	At rear of engine. See Fig. 19 .
Evaporative Emissions (EVAP) Canister Purge Solenoid (3.5L)	At top rear of the engine, near rear valve cover.
Evaporative Emissions (EVAP) Canister Vent Solenoid	On EVAP canister, in front of fuel tank.
Evaporative (EVAP) Emissions Purge Control Solenoid Valve (3.5L)	At rear of engine. See Fig. 14 .
Exhaust Gas Recirculation (EGR) Valve	At left rear of engine. See Fig. 13 .
Fuel Injectors (2.2L)	On top of engine, under fuel rail. See Fig. 19 .
Fuel Injectors (3.5L)	On top of engine, under fuel rails.
Line Pressure Control Solenoid Valve (VT25-E)	At top rear of automatic transmission. See Fig. 18 .
Rocker Arm Oil Control Solenoid (3.5L)	At lower right front of engine, near oil filter. See Fig. 14 .
Shift Control "A" (1) Solenoid (5AT)	In automatic transmission assembly. See Fig. 17 .
Shift Control "B" (2) Solenoid (5AT)	In automatic transmission assembly. See Fig. 17 .

Shift Control "C" (3) Solenoid (5AT)	In automatic transmission assembly. See Fig. 17 .
Starter Solenoid	At lower left front corner of engine, attached to start motor.
TCC Enable Solenoid Valve (VT25-E)	At top rear of automatic transmission. See Fig. 18 .
TCC Lock-Up Pressure Control Solenoid (5AT)	In automatic transmission assembly. See Fig. 17 .
TCC Pressure Control Solenoid Valve (VT25-E)	At top rear of automatic transmission. See Fig. 18 .
Torque Converter Clutch Solenoid (5AT)	In automatic transmission assembly. See Fig. 17 .

SWITCHES

SWITCHES LOCATION

Component	Location
Backup Switch (M/T)	At left side of transmission. See Fig. 15 .
Brake Fluid Level Switch	On master brake cylinder reservoir. See Fig. 25 .
Clutch Start Switch	On clutch pedal bracket.
Coolant Level Switch	At front of engine compartment, mounted on radiator.
Cruise/Brake Switch	On brake pedal bracket. See Fig. 9 .
Engine Oil Pressure (EOP) Switch (2.2L)	On engine block, near oil filter. See Fig. 20 .
Engine Oil Pressure (EOP) Switch (3.5L)	On oil pump housing, on lower right front of engine. See Fig. 14 .
Liftgate Lock Actuator/Ajar Switch	On liftgate latch. See Fig. 32 .
Low Brake Fluid Switch	In master cylinder reservoir.
Low Coolant Level Switch	On bottom of coolant surge tank.
Oil Light Reset Switch	In underhood fuse block.
Park Brake Switch	At base of park brake lever. See Fig. 25 .
Park/Neutral Position Switch (VT25-E)	At top of automatic transmission. See Fig. 18 .
Park/Neutral Position Switch (5AT)	At rear of automatic transmission. See Fig. 17 .
Rocker Arm Oil Control Switch (3.5L)	At lower right front of engine, above oil filter. See Fig. 14 .
Seat Belt Switch - Left	In driver's seat belt buckle. See Fig. 5 .
Stop Lamp Switch	On brake pedal bracket. See Fig. 9 .
Transmission Range Switch (PNP Switch)	On top of transmission.
3rd Clutch Fluid Pressure Switch (5AT)	At rear of automatic transmission. See Fig. 17 .
4th Clutch Fluid Pressure Switch (5AT)	At rear of automatic transmission. See Fig. 17 .

MISCELLANEOUS

MISCELLANEOUS LOCATION

Component	Location
A/C Diode	In underhood fuse block.

Amplifier	Under rear seat. See Fig. 10 .
Auxiliary Jack Switch Board Connector	Integral to video display console. See Fig. 11 .
Auxiliary Power Outlet	At rear of center console. See Fig. 12 .
Battery	At left front of engine compartment. See Fig. 1 .
Blower Motor Resistor	At right side of HVAC. See Fig. 26 .
Cellular Antenna	Near left rear quarter window. See Fig. 8 .
Cellular Telephone Microphone	At center front of roof. See Fig. 8 .
Cooling Fan Resistor (2.2L)	At left front of engine compartment. See Fig. 22 .
Data Link Connector (DLC)	Lower left side of dash. See Fig. 30 .
Daytime Running Lamps (DRL) Resistor	At left front corner of the vehicle. See Fig. 28 .
EPS Inline Fuse Holder	In engine compartment, on left strut tower, near a/c line.
Generator (2.2L)	At lower left front of engine. See Fig. 20 .
Generator (3.5L)	At lower right front of engine. See Fig. 21 .
GPS Antenna	At front center of roof. See Fig. 8 .
GPS Antenna Coax Lead Connection	Behind right end of dash. See Fig. 8 .
Horn	At left front of vehicle, behind headlight. See Fig. 27 .
HVAC Blower Resistor	On right side of HVAC assembly.
Ignition Coils (2.2L)	On top of engine.
Inflatable Restraint Steering Wheel Module Coil	In center of steering wheel, under module. See Fig. 6 .

CONNECTORS

CONNECTORS LOCATION

Component	Location
C100 (14 Pin)	At top front of transmission.
C102 (Black, 10 Pin)	At left rear of engine compartment.
C104 (Light Gray, 2 Pin)	Near left front wheel opening.
C105 (Light Gray, 2 Pin)	Near right front wheel opening.
C106 (Gray, 2 Pin)	At left rear of engine compartment. See Fig. 27 .
C150 (Black, 10 Pin)	At top left side of engine.
C200 (Black, 40 Pin)	Behind left kick panel. See Fig. 30 .
C201 (Gray, 2 Pin)	Under front of center console. See Fig. 29 .
C202 (Black, 16 Pin)	Behind right side of dash. See Fig. 29 .
C203 (Yellow, 4 Pin)	Behind right side of dash. See Fig. 29 .
C300 (White, 10 Pin)	On left rear wheelwell, behind left rear quarterpanel. See Fig. 8 .
C302 (Black, 8 Pin)	At right rear corner of passenger compartment. See Fig. 31 .
C303 (White, 8 Pin)	On left rear wheelwell, behind left rear quarterpanel. See Fig. 8 .
C304 (White, 4 Pin)	Under front of center console, near shifter assembly.
C305 (Black, 4 Pin)	Under left front seat. See Fig. 33 .

C306 (Black, 4 Pin)	Under right front seat. See Fig. 33 .
C307 (Yellow, 4 Pin)	Under center console, near sensing & diagnostic module. See Fig. 29 .
C308 (Yellow, 4 Pin)	Under center console, near sensing & diagnostic module. See Fig. 29 .
C400 (Black, 6 Pin)	Behind left rear taillight.
C401 (Black, 6 Pin)	Behind right rear taillight.
C402 (White, 10 Pin)	At center rear of headliner. See Fig. 32 .
C403 (Black, 2 Pin)	At center rear of headliner. See Fig. 32 .
C404 (Black, 4 Pin)	Under right rear of vehicle, near right wheel cross frame.
C405 (Black, 2 Pin)	At center of liftgate. See Fig. 32 .
C406 (Black, 10 Pin)	Under right rear of vehicle, near right wheel cross frame.
C700 (Light Gray, 2 Pin)	In left rear door.
C800 (Light Gray, 2 Pin)	In right rear door.

GROUNDS

GROUNDS LOCATION

Component	Location
G101	At left front of engine compartment. See Fig. 2 .
G103	At left side of engine compartment. See Fig. 2 .
G105	At left rear of engine. See Fig. 2 .
G107	At rear of engine. See Fig. 2 .
G109	At right front of engine, near generator. See Fig. 2 .
G201	Behind right front kick panel. See Fig. 2 .
G203	Near lower center of dash, on I/P fuse block. See Fig. 2 .
G207	Under lower left side of dash. See Fig. 2 .
G301	Under left front seat. See Fig. 2 .
G401	Under left side of luggage compartment. See Fig. 2 .
G403	Under right side of luggage compartment. See Fig. 2 .

SPLICES

SPLICES LOCATION

Component	Location
Splice Pack SP101	Behind left front headlight. See Fig. 2 .
Splice Pack SP113	At right side of engine, under intake air duct. See Fig. 14 .
Splice Pack SP114	At right side of engine, under intake air duct. See Fig. 14 .
Splice Pack SP201	Behind right front kick panel. See Fig. 2 .

Splice Pack SP203	Taped to harness, behind data link connector. See Fig. 2 .
Splice Pack SP301	Under left front seat. See Fig. 2 .
Splice Pack SP401	At left rear of storage compartment. See Fig. 2 .
Splice Pack SP403	At right rear of storage compartment. See Fig. 2 .
S100	In engine harness, near breakout for engine control module.
S101	In fuel injector harness, near C150.
S103	In engine harness, near automatic transmission C1 connector.
S104	In engine harness, near automatic transmission C1 connector.
S109	In engine harness, at breakout for throttle actuator control module.
S110	In engine harness, at breakout for throttle actuator control module.
S111	In forward lamp harness, near underhood fuse block. See Fig. 27 .
S112	In engine harness, in EGR valve circuit.
S115	In engine harness, in EGR valve circuit.
S119	In engine harness, in bank 2 HO2 sensors circuit.
S120	In engine harness, in A/C pressure sensor circuit.
S121	In engine harness, in bank 1 HO2 sensors circuit.
S122	In engine harness, in bank 1 HO2 sensors circuit.
S123	In engine harness, in TFT sensor circuit.
S124	In engine harness, in EGR valve circuit.
S125	In engine harness, in ICM 1 circuit.
S129	In engine harness, in TAC module circuit.
S130	In engine harness, in ICM 4 circuit.
S131	In engine harness, in ICM 6 circuit.
S132	In engine harness, in CKP sensor circuit.
S133	In engine harness, in valve timing switch circuit.
S135	In engine harness, in CKP sensor circuit.
S200	In I/P harness, between radio & dash fuse block harness.
S201	In I/P harness, between hazard switch harness & radio harness breakouts. See Fig. 29 .
S203	In I/P harness, between body control module & dash fuse block breakout. See Fig. 30 .
S204	In body harness, near pass-through grommet under left side of dash.
S205	In I/P harness, between HVAC & radio harness breakout. See Fig. 29 .
S206	In HVAC harness, between defrost mode & panel mode actuator harness breakout.
S207	In HVAC harness, between C202 & panel mode actuator harness breakout.
S209	In body harness, under center of dash, near dash fuse block breakout.
S301	In headliner harness, near breakout for mirror & front reading lights. See Fig. 31 .

S302	In headliner harness, near breakout for rear dome light switch harness. See Fig. 31 .
S303	In headliner harness, near breakout for rear dome light switch harness. See Fig. 31 .
S304	In body harness, near cross car breakout.
S400	In body harness. See Fig. 32 .
S401	In fuel tank jumper harness.
S402	In liftgate harness, near C402. See Fig. 32 .
S403	In left taillight harness.
S404	In left taillight harness.
S405	In right taillight harness.
S406	In right taillight harness.
S407	In liftgate harness, near passthrough to headliner. See Fig. 32 .
S500	In body harness, inside left front door.
S501	In body harness, inside left front door.
S600	In body harness, inside right front door.
S601	In body harness, inside right front door.
S1134	In engine harness, in PCM data sensors low reference circuit.

COMPONENT LOCATION GRAPHICS

NOTE: Figures may show multiple component locations. Refer to appropriate table for proper figure references.

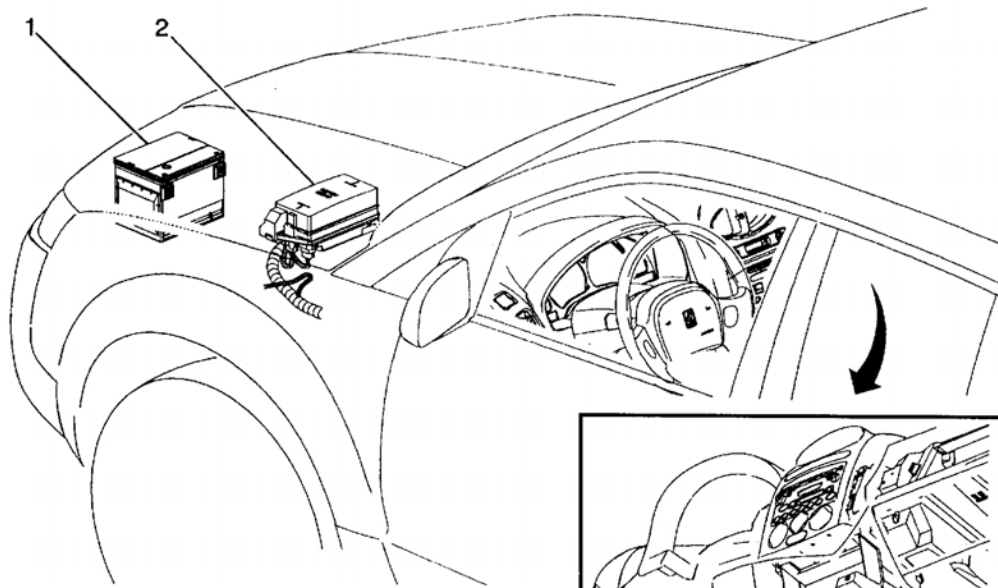

- (1) Battery
- (2) Fuse Block-Underhood
- (3) Fuse Block-I/P

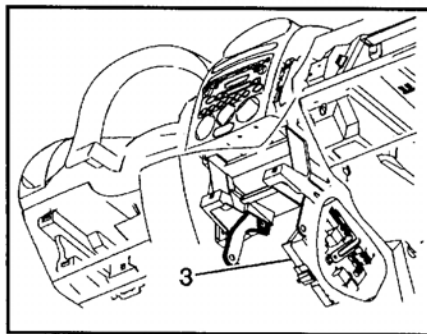

G00259139

Fig. 1: Engine Compartment & Center Of Dash
Courtesy of GENERAL MOTORS CORP.

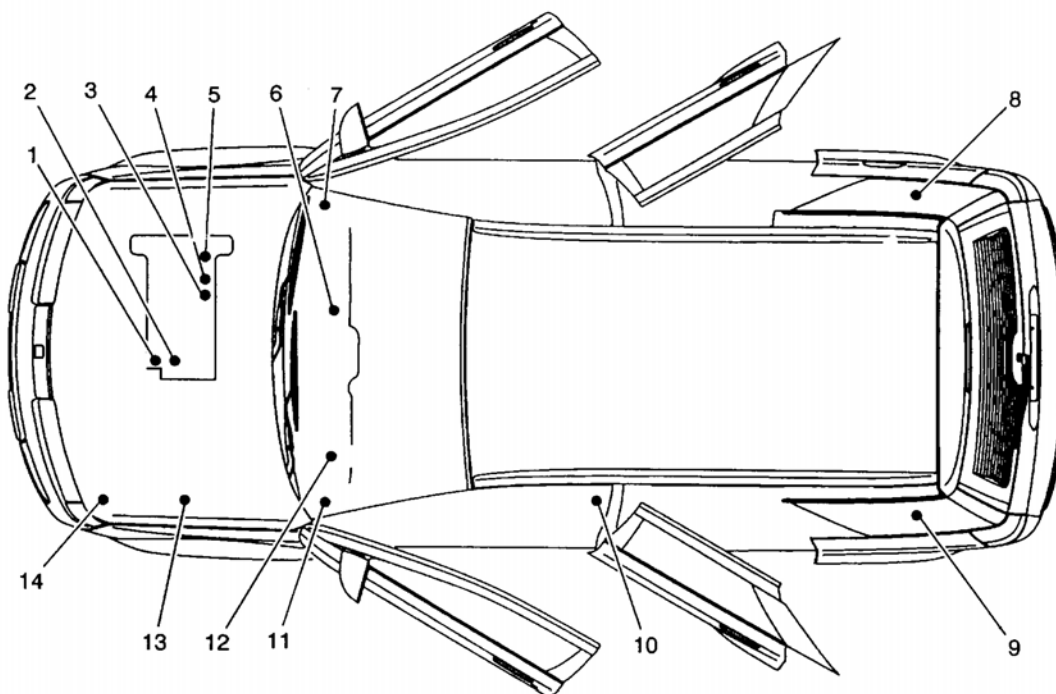

- (1) G105
- (2) G107
- (3) Splice Pack SP114 (w/ L66 Only)
- (4) Splice Pack SP113 (w/ L66 Only)
- (5) G109 (w/ L66 Only)
- (6) G203 (Secured on I/P Fuse Block)
- (7) G201, Splice Pack SP201
- (8) G403, Splice Pack SP403
- (9) G401, Splice Pack SP401
- (10) G301, Splice Pack SP301
- (11) Splice Pack SP203
- (12) G207
- (13) G103
- (14) G101, Splice Pack SP101

G00259140

Fig. 2: Ground & Splice Locations
 Courtesy of GENERAL MOTORS CORP.

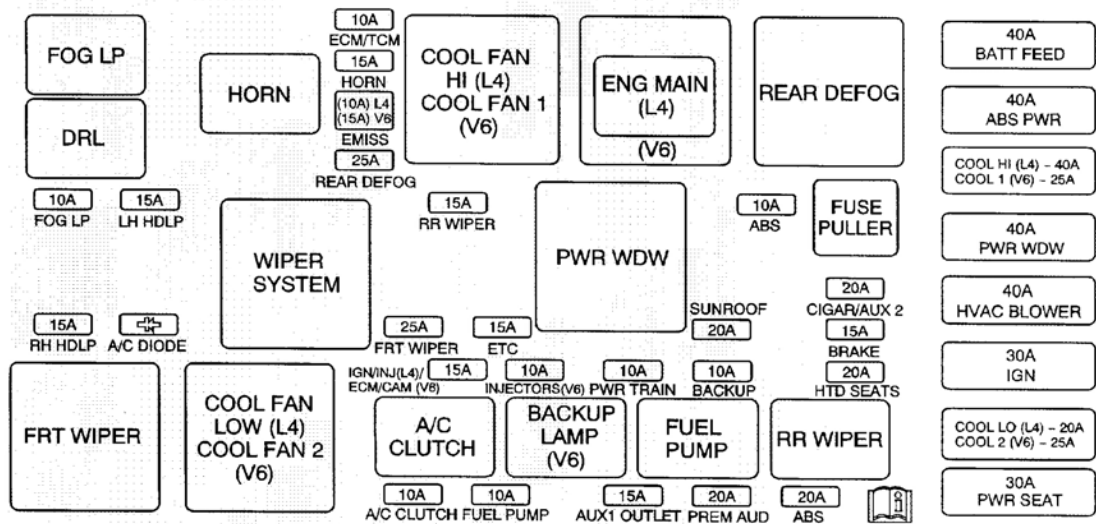

G00259141

Fig. 3: Fuse Block - Underhood
 Courtesy of GENERAL MOTORS CORP.

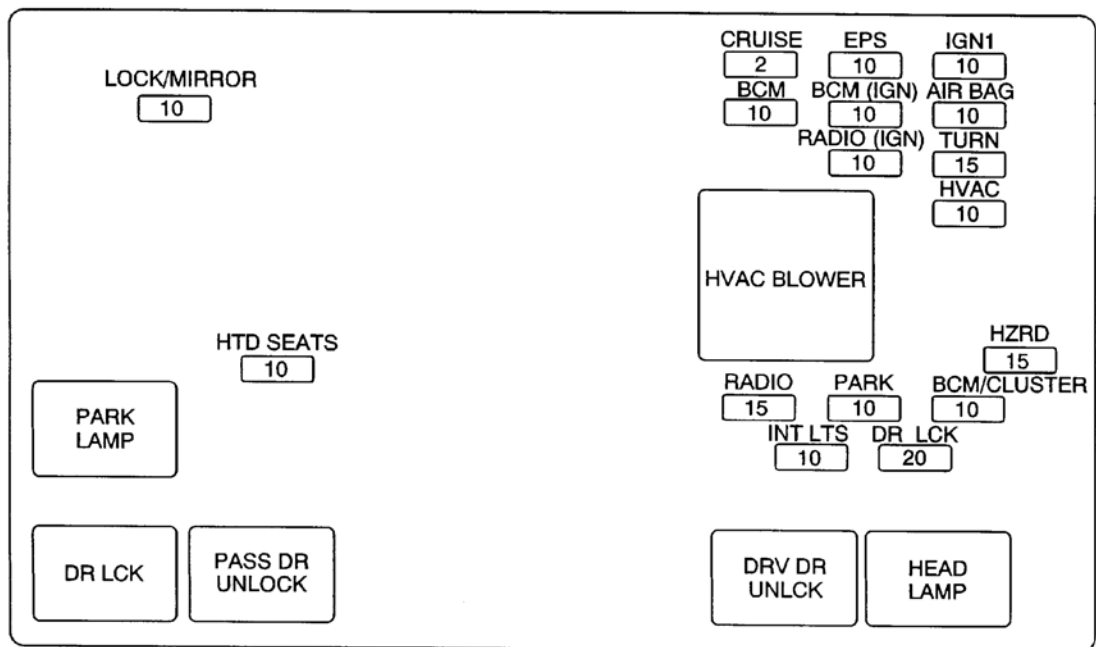

G00259142

Fig. 4: Instrument Panel Fuse Block
 Courtesy of GENERAL MOTORS CORP.

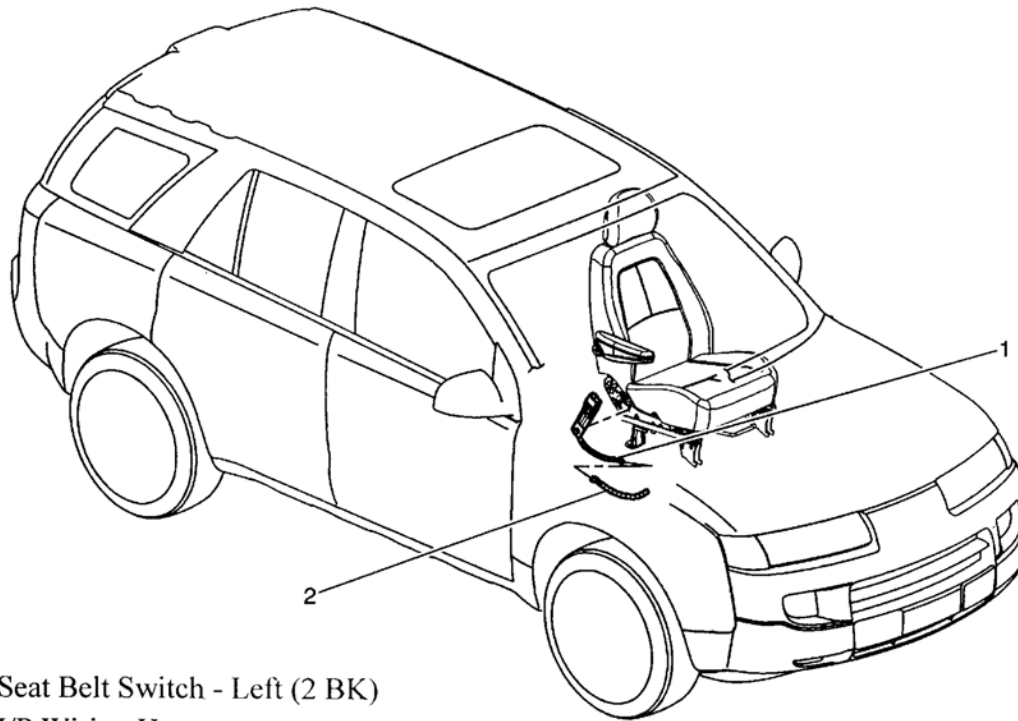

- (1) Seat Belt Switch - Left (2 BK)
- (2) I/P Wiring Harness

G00259143

Fig. 5: Driver Seat
Courtesy of GENERAL MOTORS CORP.

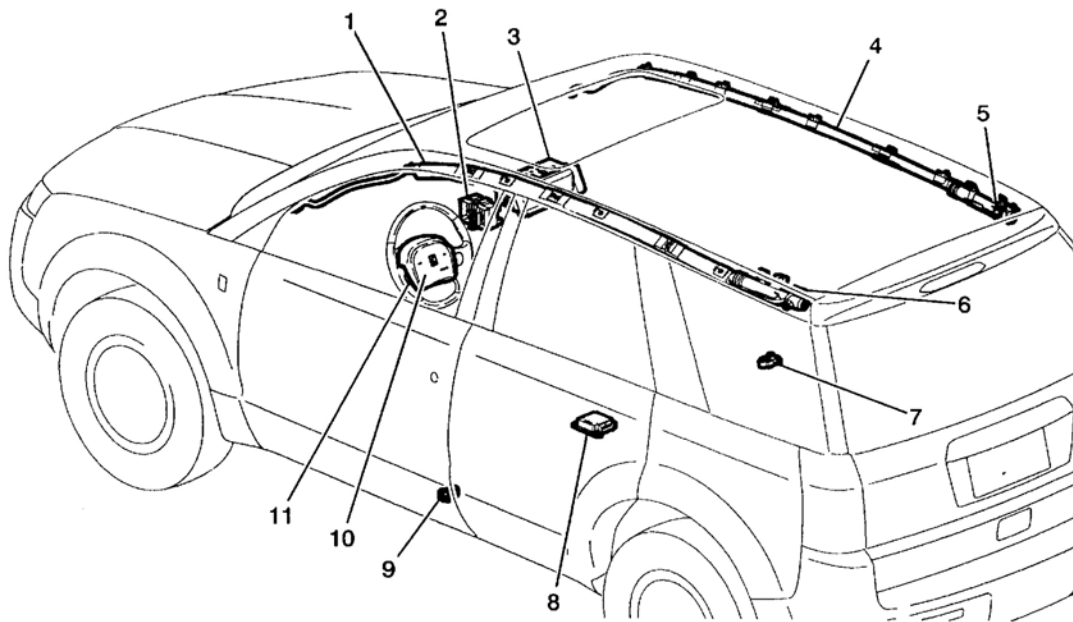

- (1) Inflatable Restraint Roof Rail Module - Left
- (2) Fuse Block - I/P
- (3) Inflatable Restraint I/P Module
- (4) Inflatable Restraint Roof Rail Module - Right
- (5) Inflatable Restraint Roof Rail Module - Right Disable Connector
- (6) Inflatable Restraint Roof Rail Module - Left Disable Connector
- (7) Inflatable Restraint Side Impact Sensor (SIS) - Right
- (8) Inflatable Restraint Sensing and Diagnostic Module (SDM)
- (9) Inflatable Restraint Side Impact Sensor (SIS) - Left
- (10) Inflatable Restraint Steering Wheel Module Coil (Hidden Beneath Module)
- (11) Inflatable Restraint Steering Wheel Module

G00259144

Fig. 6: SIR Component Views (Wagon)
Courtesy of GENERAL MOTORS CORP.

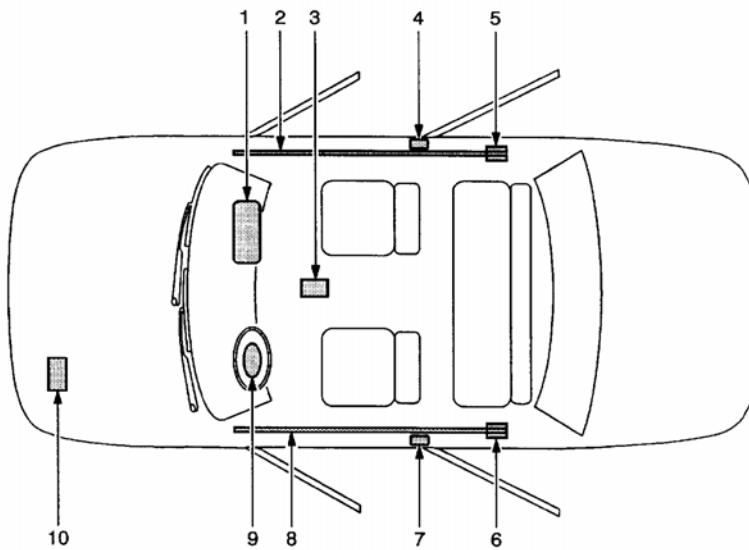

- (1) I/P Air Bag-Located at the top right under the instrument panel
- (2) Roof Rail Air Bag-Right--Located under the headliner, extending from the passenger front windshield pillar to the passenger rear windshield pillar
- (3) Sensing and Diagnostic Module (SDM)-Located underneath the vehicle carpet under the center console
- (4) Side Impact Sensor (SIS) and Seat Belt Pretensioner-RF--Located under the trim near the bottom of the center pillar
- (5) Roof Rail Module-Right--Located behind the garnish molding on the upper rear pillar
- (6) Roof Rail Module-Left--Located behind garnish molding on the upper rear pillar
- (7) Side Impact Sensor (SIS) and Seat Belt Pretensioner-LF--Located under the trim near the bottom of the center pillar
- (8) Roof Rail Air Bag-Left--Located under the headliner, extending from the driver front windshield pillar to the driver rear windshield pillar
- (9) Steering Wheel Air Bag-Located on the steering wheel
- (10) Vehicle Battery-Located at the front left of the engine compartment.

G00259145

Fig. 7: SIR Component Views (Sedan)
Courtesy of GENERAL MOTORS CORP.

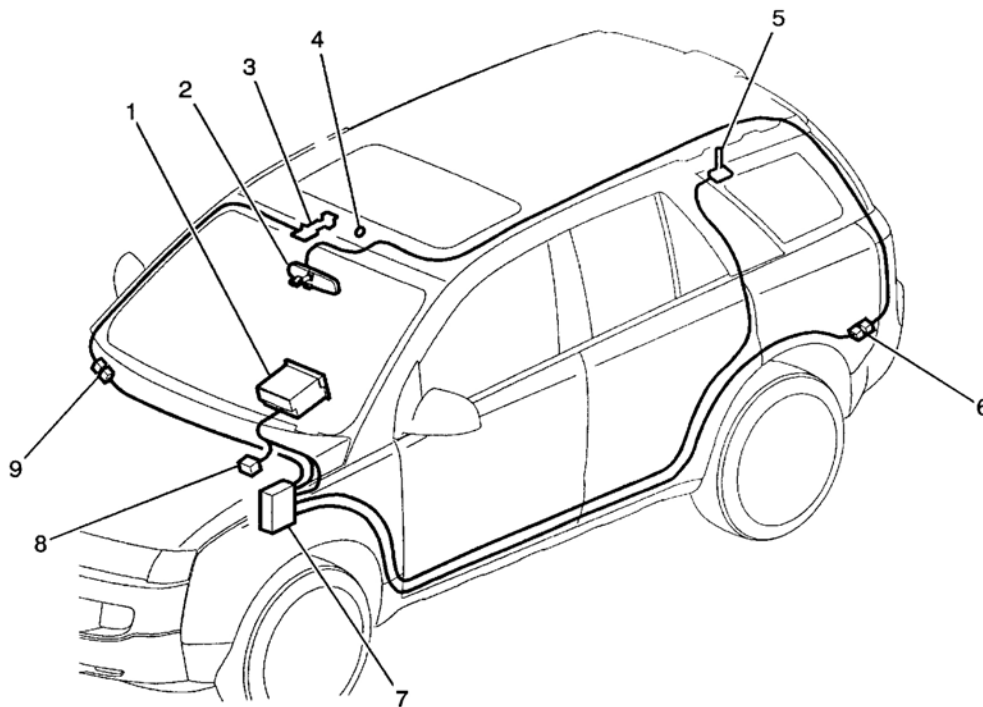

- (1) Radio
- (2) Inside Rearview Mirror (ISRM) (w/ Onstar Switches)
- (3) GPS Antenna
- (4) Cellular Telephone Microphone
- (5) Cellular Antenna
- (6) C300 and C303
- (7) Vehicle Communication Interface Module (VCIM)
- (8) Hazard Switch, Dimmer Switch, Traction Control Switch Connectors
- (9) GPS Antenna Coax Lead Connection

G00259146

Fig. 8: Cellular Communication Components
Courtesy of GENERAL MOTORS CORP.

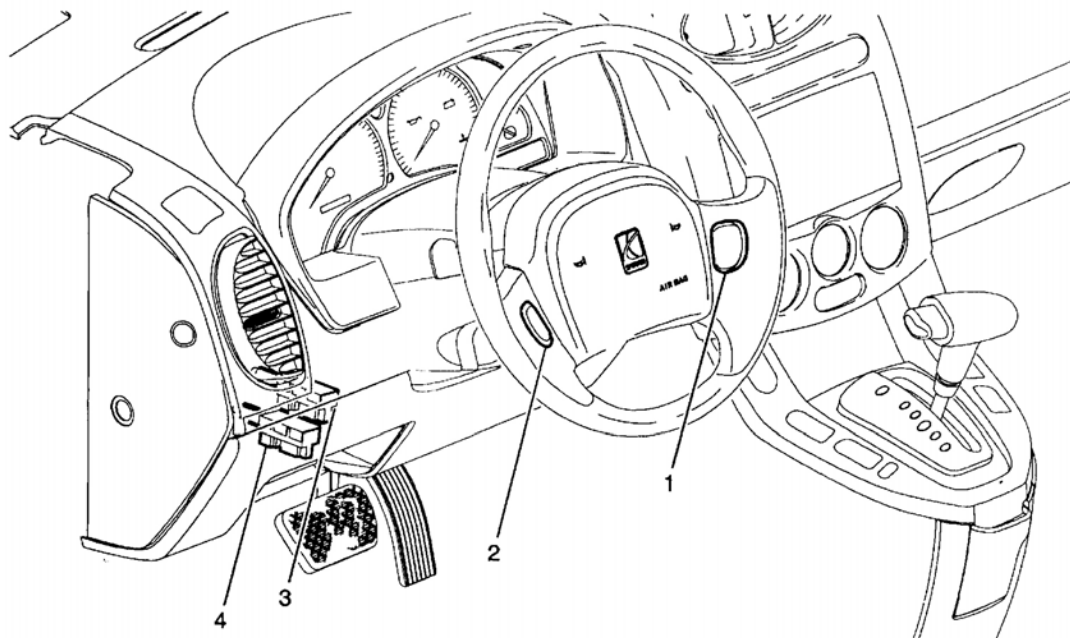

- (1) Cruise Set/Resume Switch
- (2) Cruise On/Off Switch
- (3) Cruise/Brake Switch
- (4) Stop Lamp Switch

G00259147

Fig. 9: Left Side Of Dash
Courtesy of GENERAL MOTORS CORP.

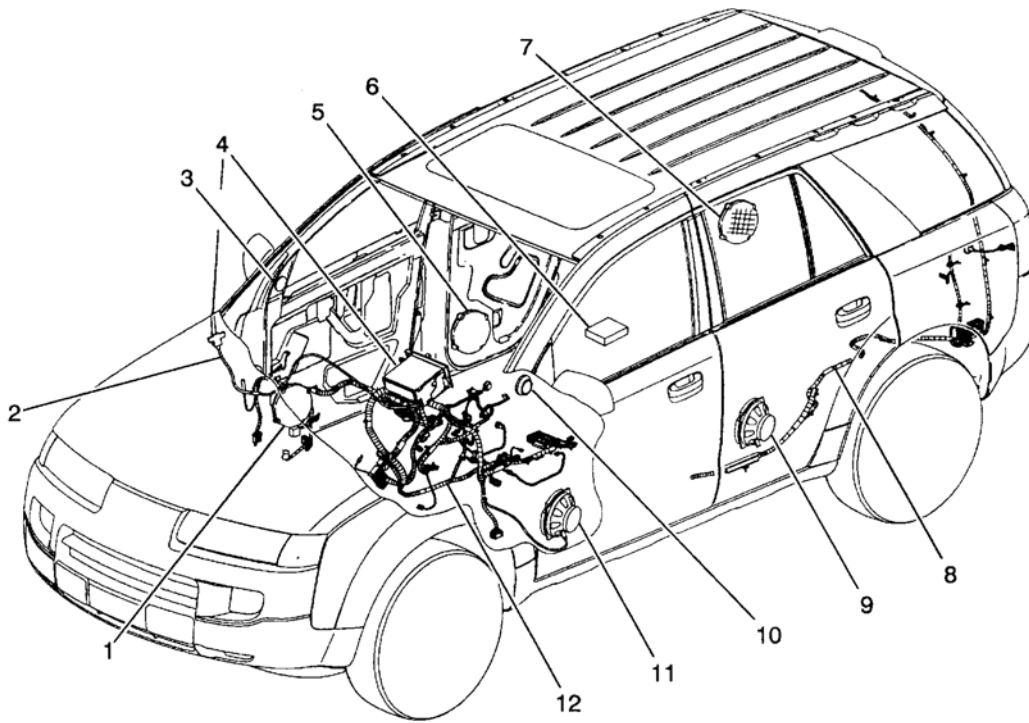

- (1) Speaker - RF
- (2) Radio Antenna Lead
- (3) Speaker - RF (Tweeter - w/UW6/WBM)
- (4) Radio
- (5) Speaker - RR
- (6) Amplifier (WBM w/ UR9/UP0)
- (7) Subwoofer (WBM w/ UR9/UP0)
- (8) Body Harness
- (9) Speaker - LR
- (10) Speaker - LF (Tweeter - w/UW6/WBM)
- (11) Speaker - LF
- (12) I/P Harness

G00259148

Fig. 10: Stereo System Components
 Courtesy of GENERAL MOTORS CORP.

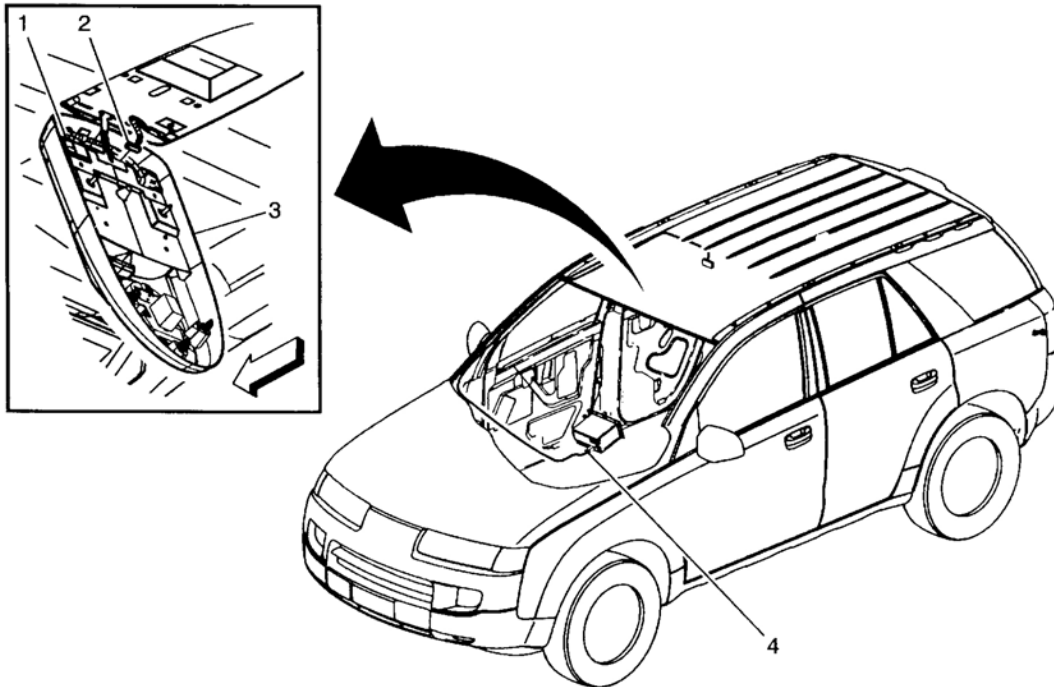

- (1) Auxiliary Jack Switch Board Connector (Part of the Video Display)
- (2) Video Display (16 BK)
- (3) Video Display Console
- (4) Radio C3 (16 BK)

G00259149

Fig. 11: Center Front Of Roof
Courtesy of GENERAL MOTORS CORP.

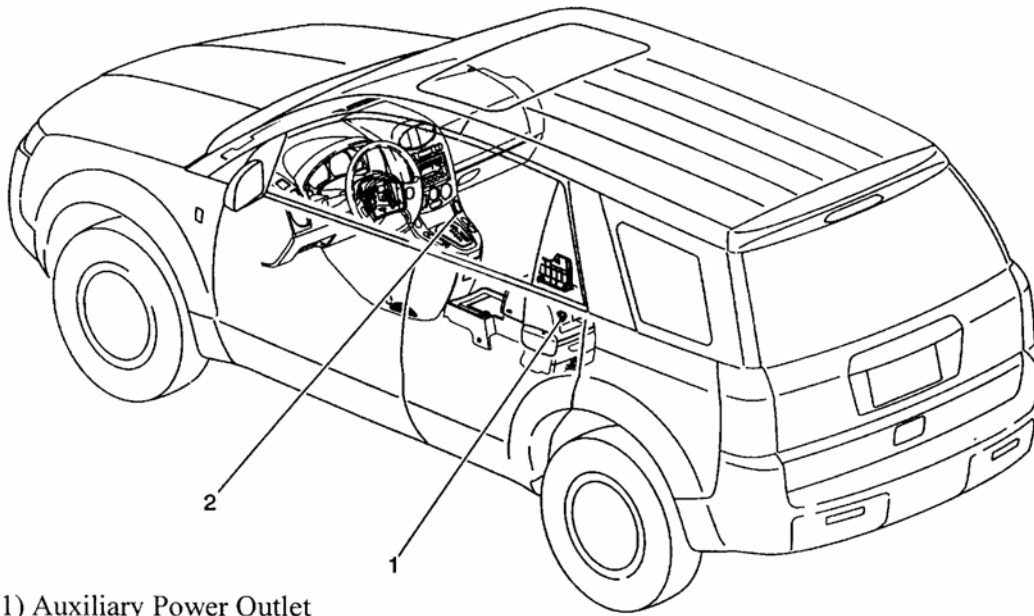

- (1) Auxiliary Power Outlet
- (2) Cigar Lighter

G00259150

Fig. 12: Center Console
Courtesy of GENERAL MOTORS CORP.

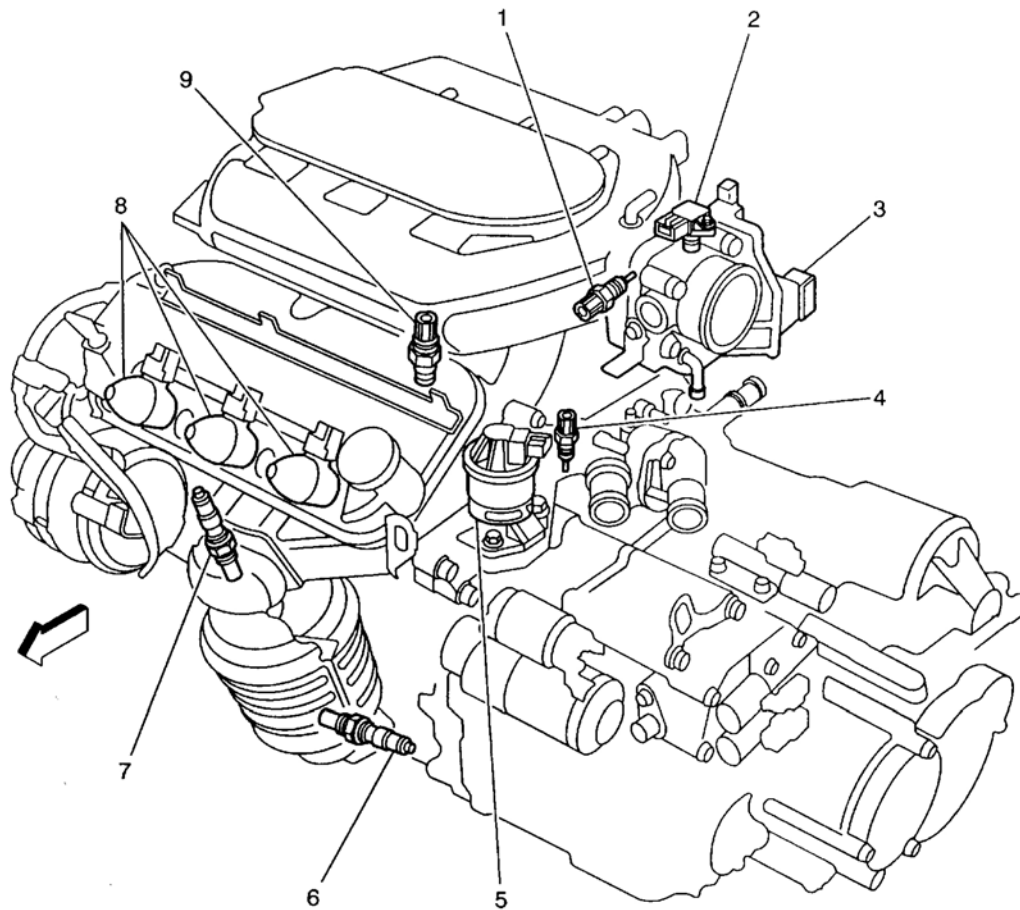

- (1) Intake Air Temperature (IAT) Sensor 2 (Sensor 1 in the Air Cleaner Housing)
- (2) Manifold Absolute Pressure (MAP) Sensor
- (3) Throttle Actuator Control (TAC) Module
- (4) Engine Coolant Temperature (ECT) Sensor
- (5) Exhaust Gas Recirculation (EGR) Valve
- (6) Heated Oxygen Sensor (HO2S) Bank 2 Sensor 2
- (7) Heated Oxygen Sensor (HO2S) Bank 2 Sensor 1
- (8) Ignition Control Modules (ICM) 4, 5, and 6
- (9) Knock Sensor (KS)

G00259151

Fig. 13: Left Rear Of Engine (3.5L)
 Courtesy of GENERAL MOTORS CORP.

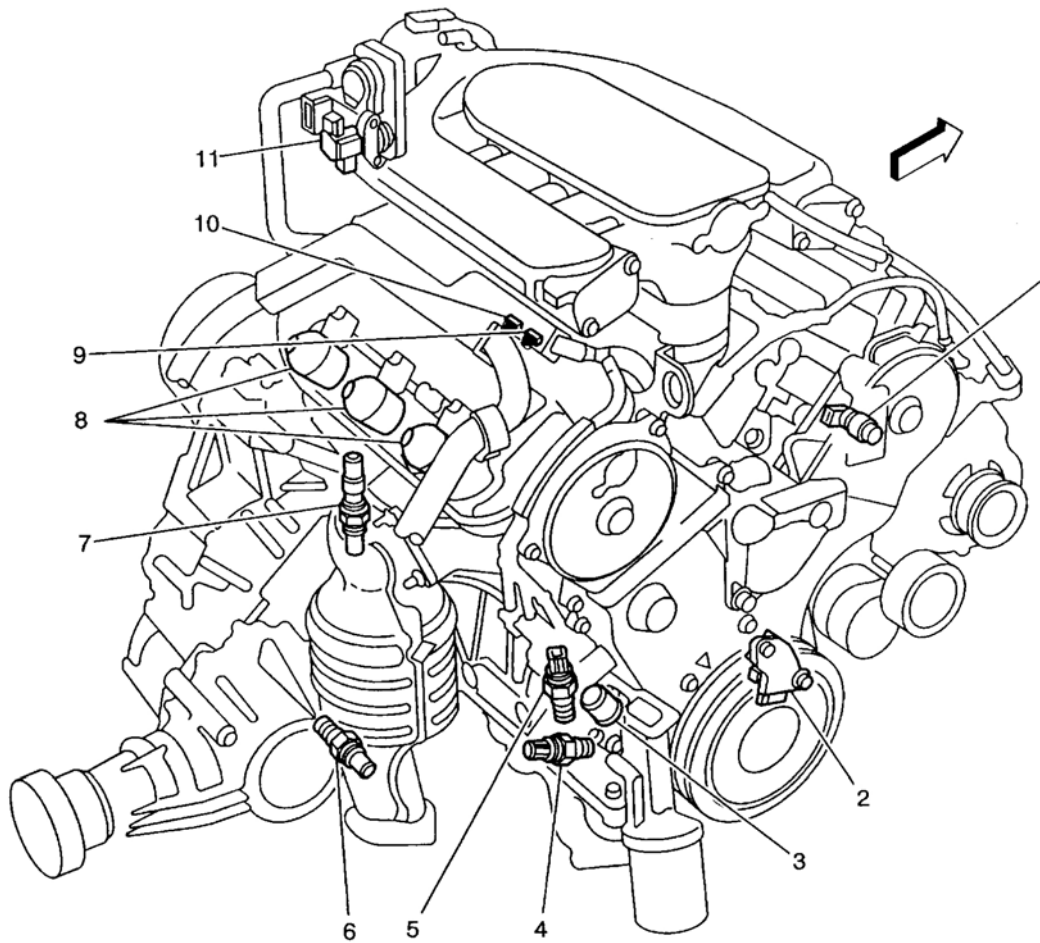

- (1) Camshaft Position (CMP) Sensor
- (2) Crankshaft Position (CKP) Sensor
- (3) Rocker Arm Oil Control Solenoid
- (4) Rocker Arm Oil Pressure Switch
- (5) Engine Oil Pressure (EOP) Switch
- (6) Heated Oxygen Sensor (HO2S) Bank 1 Sensor 2
- (7) Heated Oxygen Sensor (HO2S) Bank 1 Sensor 1
- (8) Ignition Control Modules (ICM) 1, 2, and 3
- (9) Splice Pack SP113
- (10) Splice Pack SP114
- (11) Evaporative (EVAP) Emissions Purge Control Solenoid Valve

G00259152

Fig. 14: Right Front Of Engine (3.5L)
Courtesy of GENERAL MOTORS CORP.

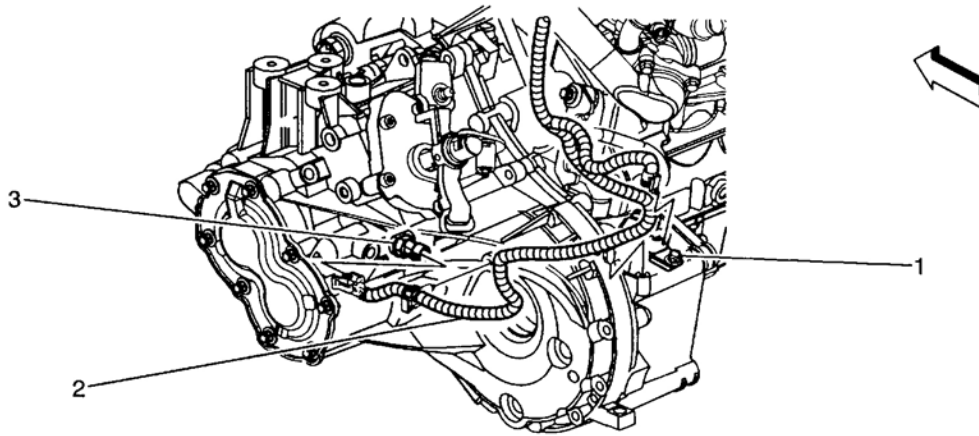

- (1) Vehicle Speed Sensor (VSS) (3 BK)
- (2) Engine Wiring Harness
- (3) Backup Switch (2 BK)

G00259153

Fig. 15: Left Side Of Manual Transmission
Courtesy of GENERAL MOTORS CORP.

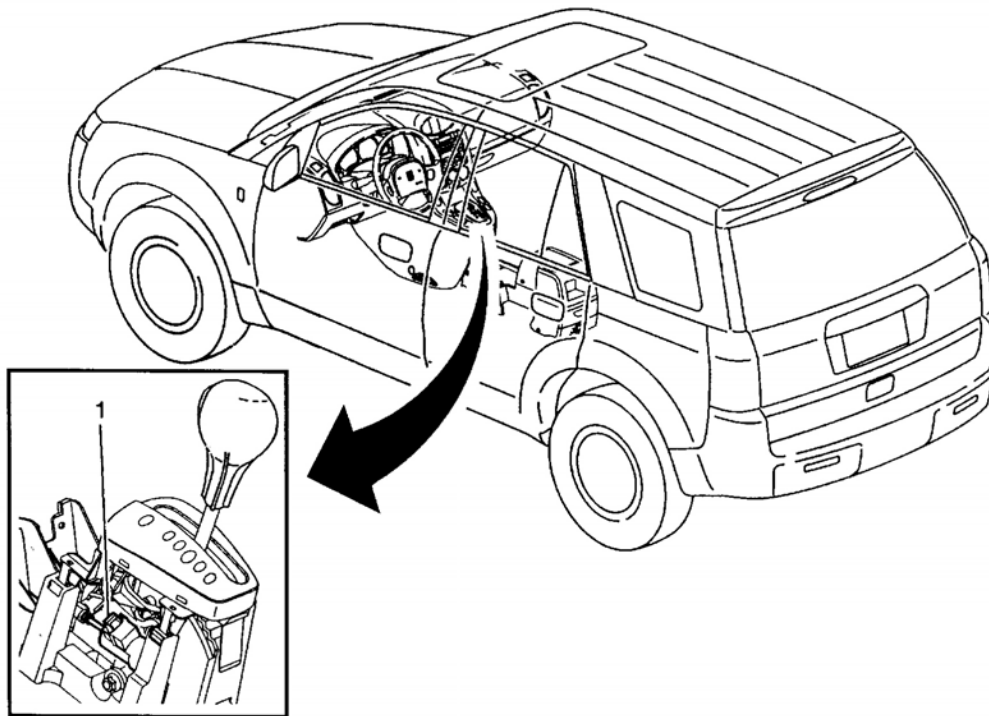

(1) A/T Shift Lock Solenoid (2 BK)

G00259154

Fig. 16: Front Center Console
Courtesy of GENERAL MOTORS CORP.

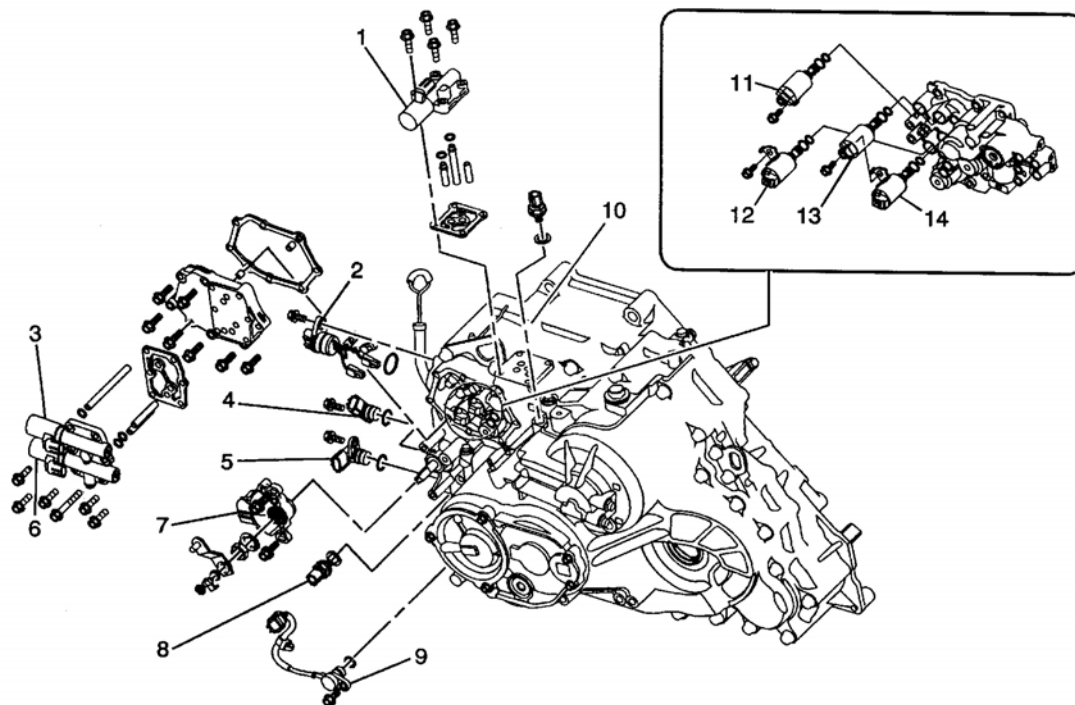

- (1) Solenoid - TCC Lock-Up Pressure Control
- (2) Harness Assembly - Automatic Transmission Wiring
- (3) Solenoid - Automatic Transmission Clutch Pressure Control "A" (1)
- (4) Sensor - Input Speed
- (5) Sensor - Output Speed
- (6) Solenoid - Automatic Transmission Clutch Pressure Control "B" (2)
- (7) Switch - Park/Neutral Position
- (8) Switch - 3rd Clutch Fluid Pressure
- (9) Sensor - Automatic Transmission Fluid Temperature, w/Harness
- (10) Switch - 4th Clutch Fluid Pressure
- (11) Solenoid - Shift Control "A" (1)
- (12) Solenoid - Shift Control "B" (2)
- (13) Solenoid - Shift Control "C" (3)
- (14) Solenoid - Torque Converter Clutch

G00259155

Fig. 17: Automatic Transmission (5AT)
 Courtesy of GENERAL MOTORS CORP.

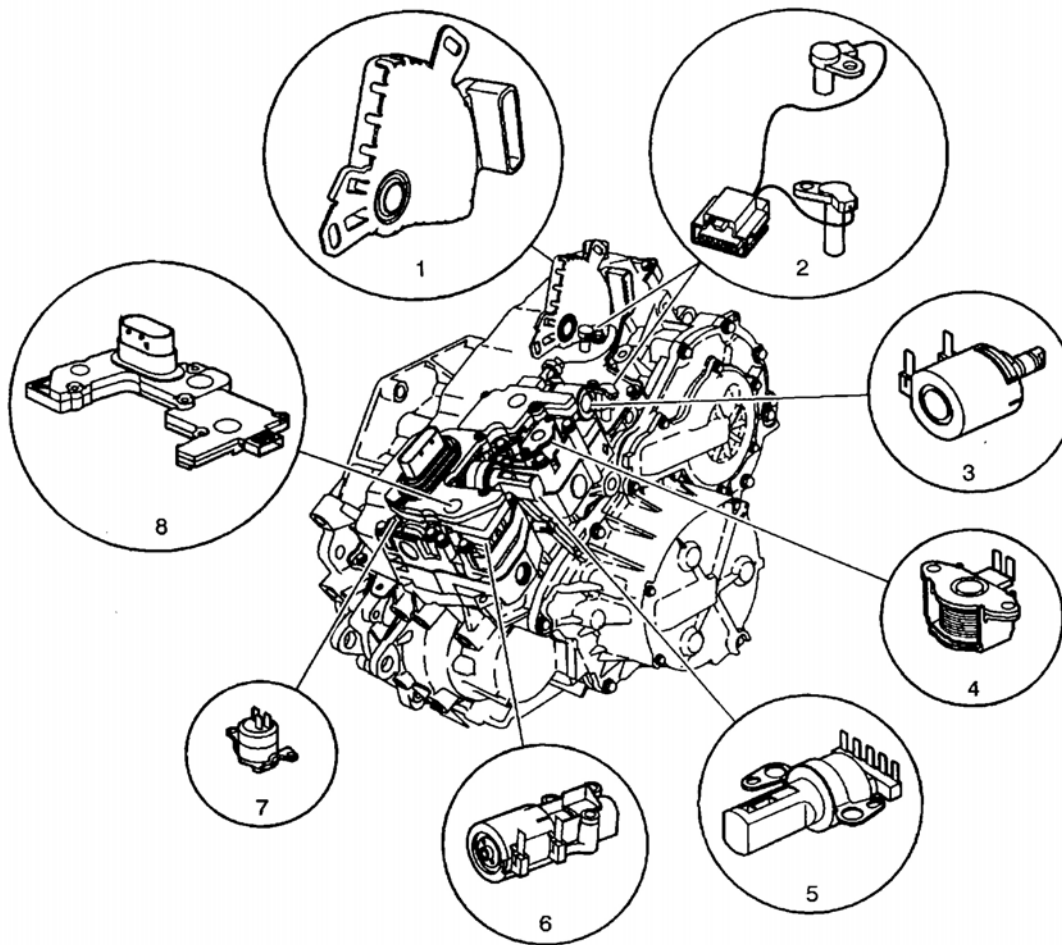

- (1) Park/Neutral Position Switch Assembly (39)
- (2) Automatic Transmission Input and Output Speed Sensor Assembly (74)
- (3) TCC Pressure Control Solenoid Valve
- (4) TCC Enable Solenoid Valve
- (5) Ratio Control Motor
- (6) Line Pressure Control Solenoid Valve
- (7) Transmission Fluid Pressure Sensor
- (8) Module Leadframe

G00259156

Fig. 18: Automatic Transmission (VT25-E)
Courtesy of GENERAL MOTORS CORP.

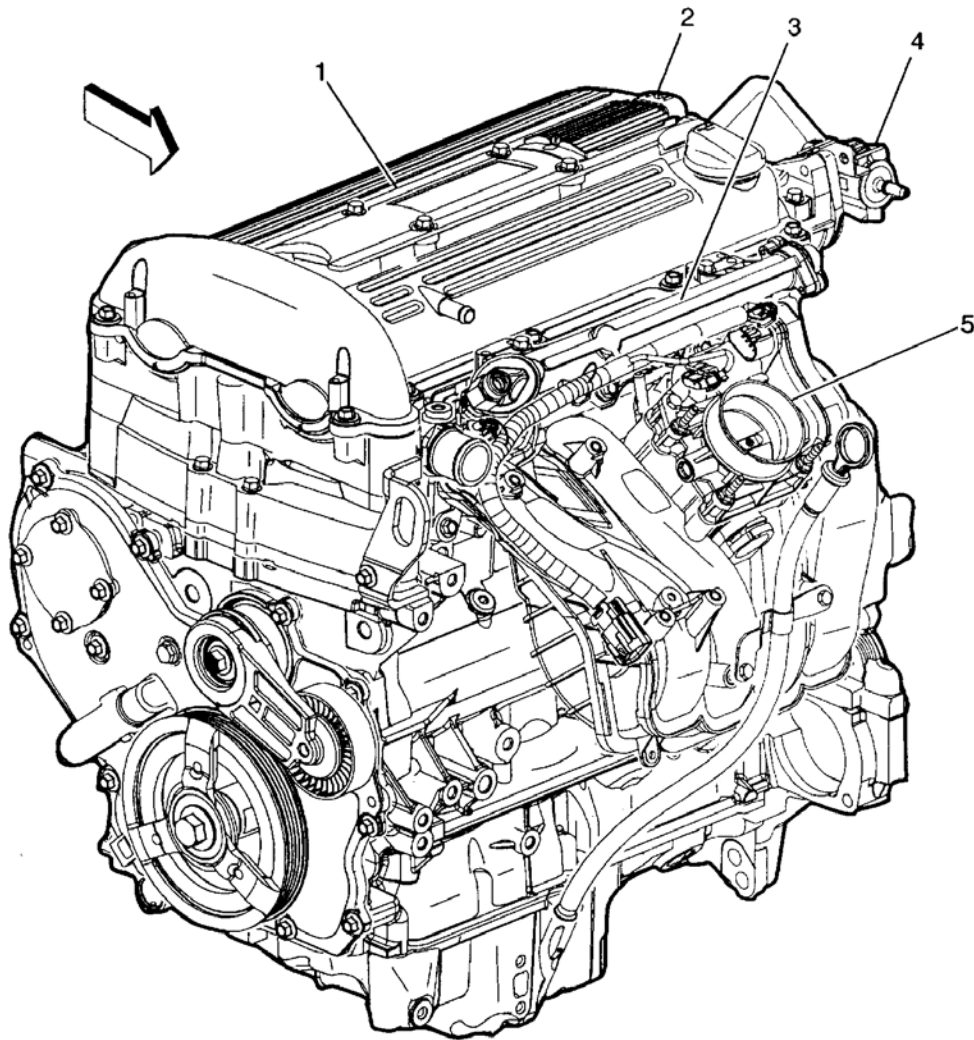

- (1) Ignition Coil Housing
- (2) Ignition Control Module (ICM)
- (3) Fuel Rail and Injectors
- (4) Evaporative Emissions (EVAP) Canister Purge Solenoid
- (5) Throttle Body and Throttle Actuator Control (TAC) Module

G00259157

Fig. 19: Left Side Of Engine (2.2L)
Courtesy of GENERAL MOTORS CORP.

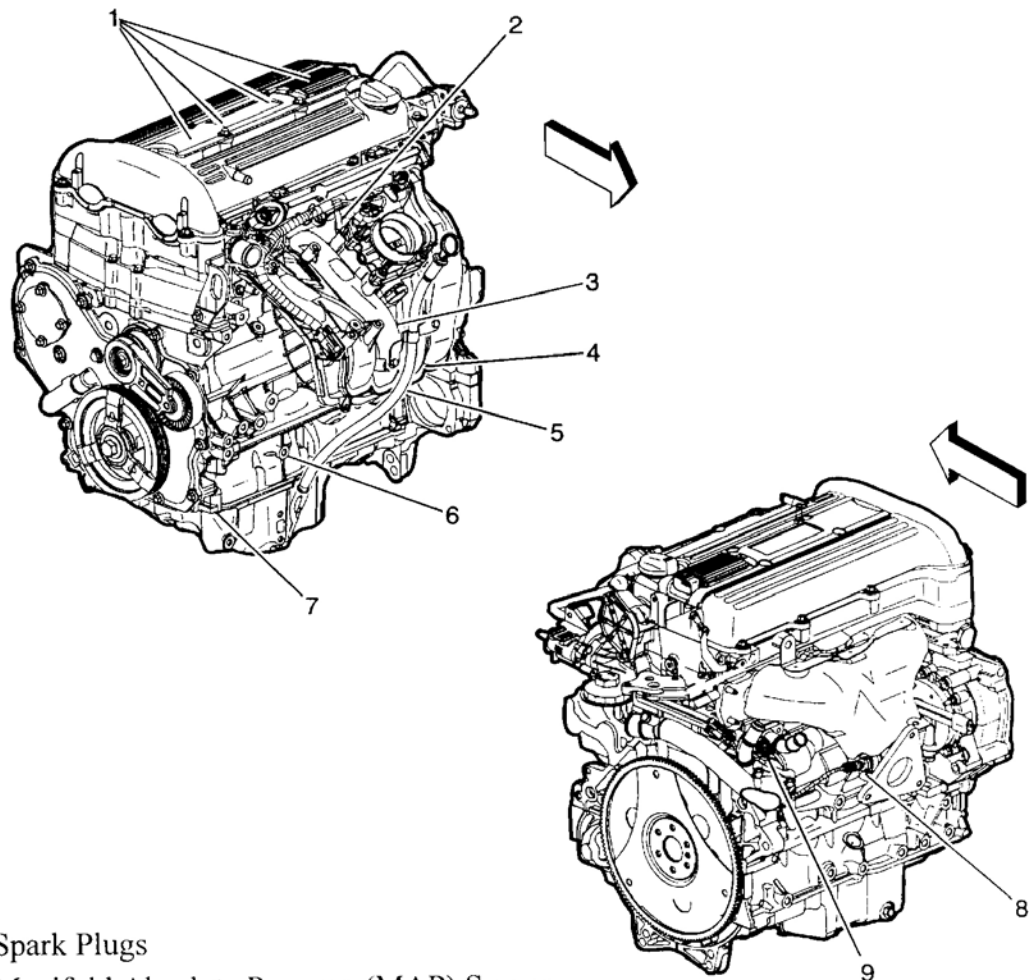

- (1) Spark Plugs
- (2) Manifold Absolute Pressure (MAP) Sensor
- (3) Knock Sensor (KS)
- (4) Crankshaft Position (CKP) Sensor
- (5) Engine Oil Pressure (EOP) Switch
- (6) Generator Mounting Location
- (7) A/C Compressor Clutch Location
- (8) Heated Oxygen Sensor (HO2S) Sensor 1
- (9) Engine Coolant Temperature (ECT) Sensor

G00259158

Fig. 20: Left & Right Side Of Engine (2.2L)
Courtesy of GENERAL MOTORS CORP.

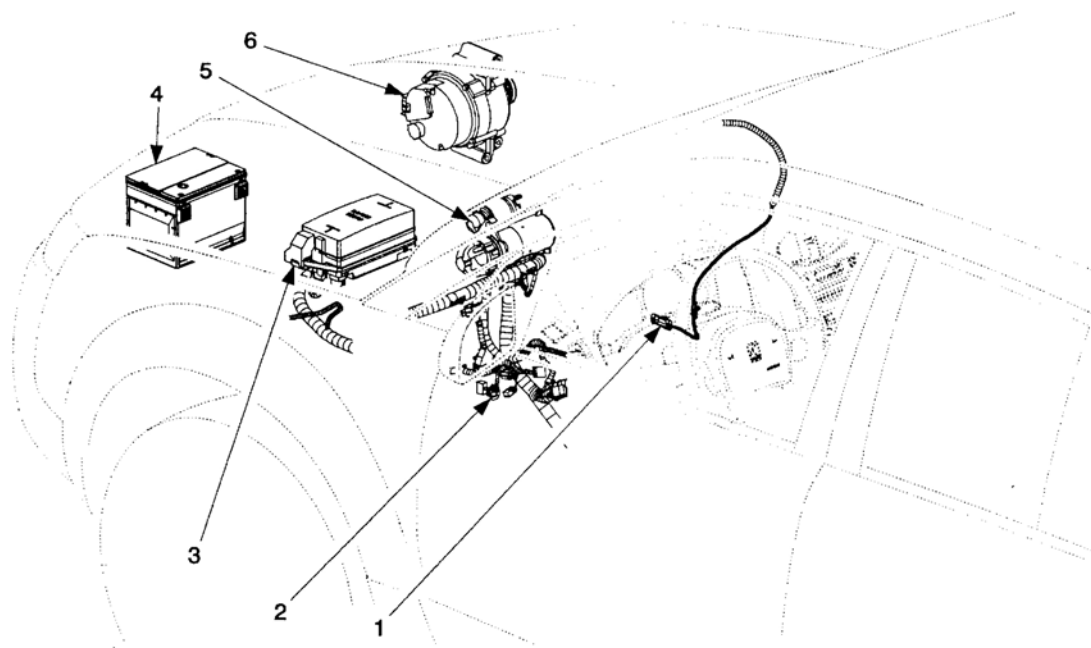

- (1) Ignition Switch
- (2) Park/Neutral Position (PNP) Switch
- (3) Underhood Fuse Block
- (4) Battery
- (5) Starter
- (6) Generator

G00259159

Fig. 21: Engine Compartment
Courtesy of GENERAL MOTORS CORP.

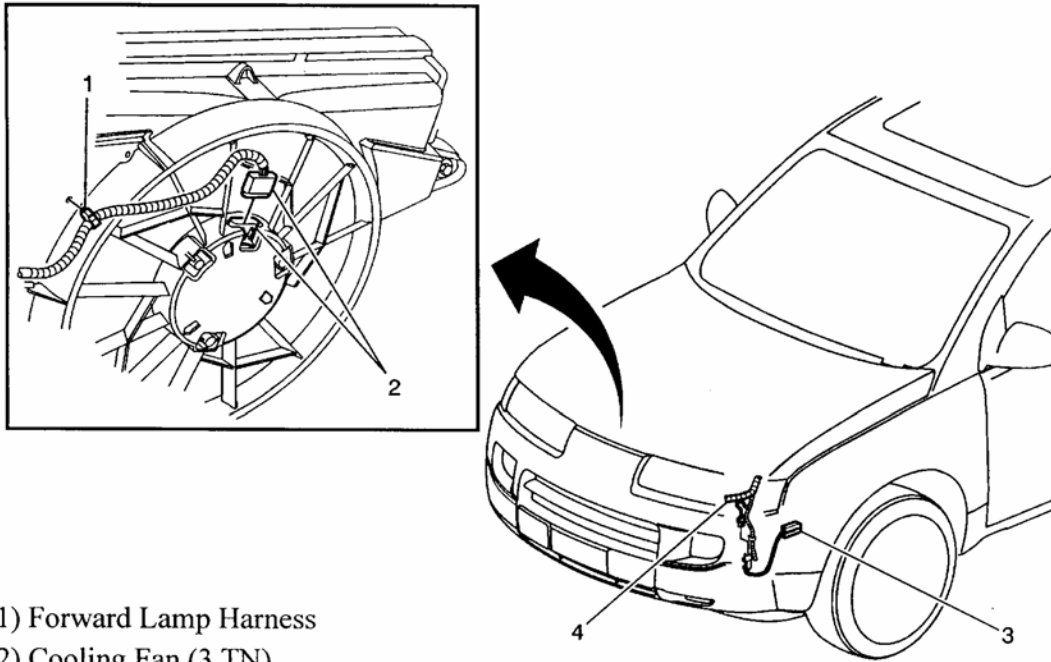

- (1) Forward Lamp Harness
- (2) Cooling Fan (3 TN)
- (3) Cooling Fan Resistor (2 GY)
- (4) Forward Lamp Harness

G00259160

Fig. 22: Front Of Engine Compartment (2.2L)
Courtesy of GENERAL MOTORS CORP.

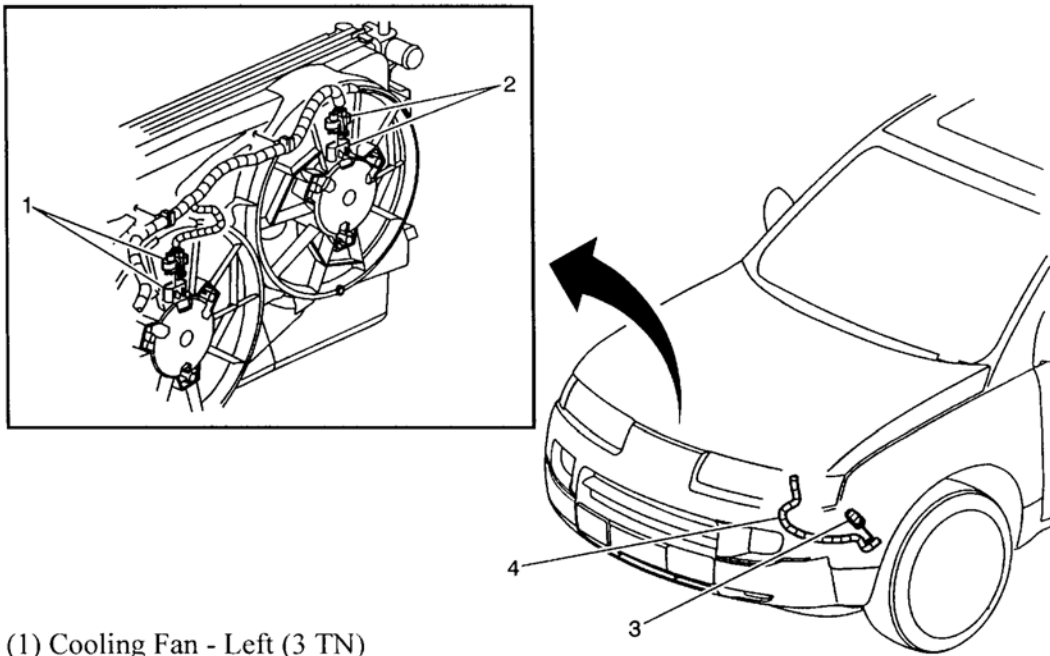

- (1) Cooling Fan - Left (3 TN)
- (2) Cooling Fan - Right (3 TN)
- (3) Cooling Fan Relay 3 (5 BK)
- (4) Forward Lamp Harness

G00259161

Fig. 23: Front Of Engine Compartment (3.5L)
Courtesy of GENERAL MOTORS CORP.

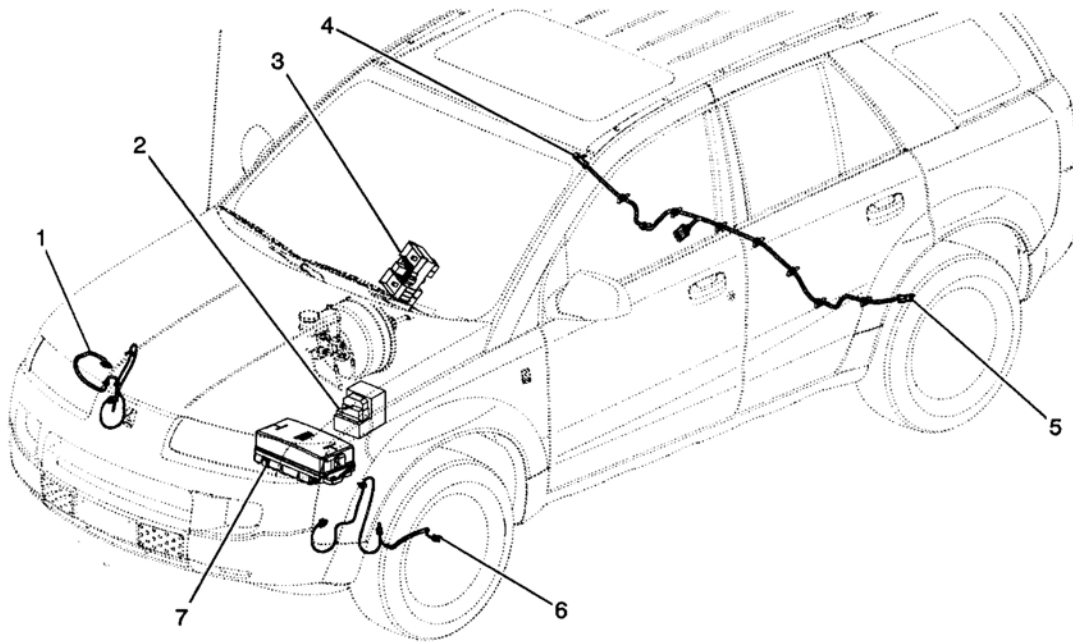

- (1) Wheel Speed Sensor (WSS) - RF
- (2) Electronic Brake Control Module (EBCM)
- (3) Fuse Block - I/P
- (4) Wheel Speed Sensor (WSS) - RR
- (5) Wheel Speed Sensor (WSS) - LR
- (6) Wheel Speed Sensor (WSS) - LF
- (7) Fuse Block - Underhood

G00259162

Fig. 24: ABS Component Views
Courtesy of GENERAL MOTORS CORP.

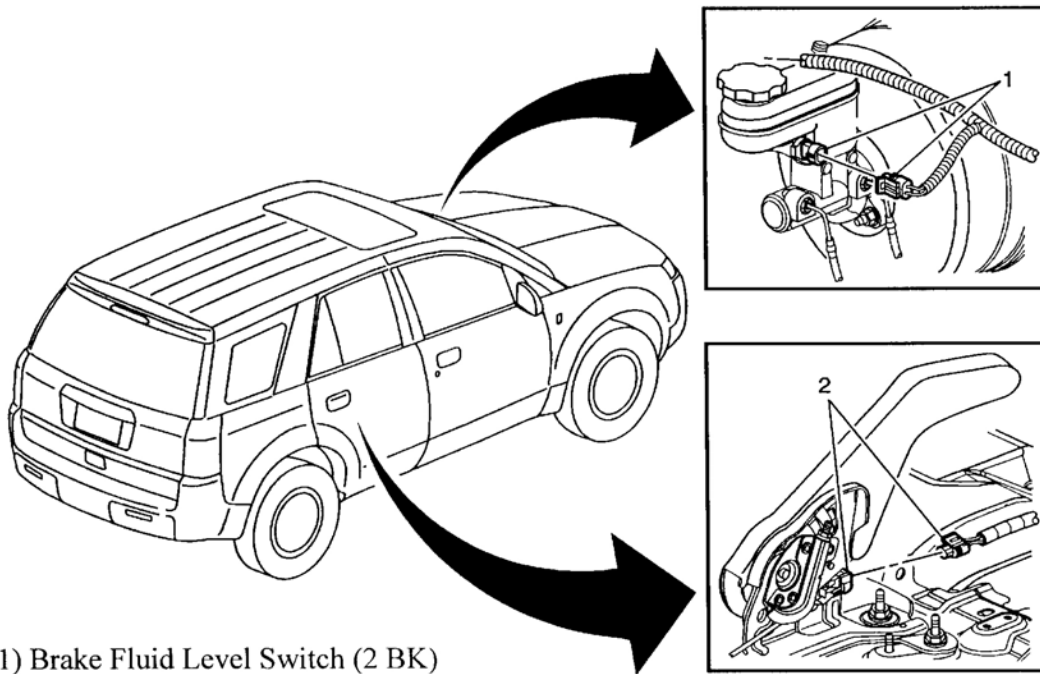

- (1) Brake Fluid Level Switch (2 BK)
- (2) Park Brake Switch (1 BK)

G00259163

Fig. 25: Left Rear Of Engine Compartment & Under Center Console
Courtesy of GENERAL MOTORS CORP.

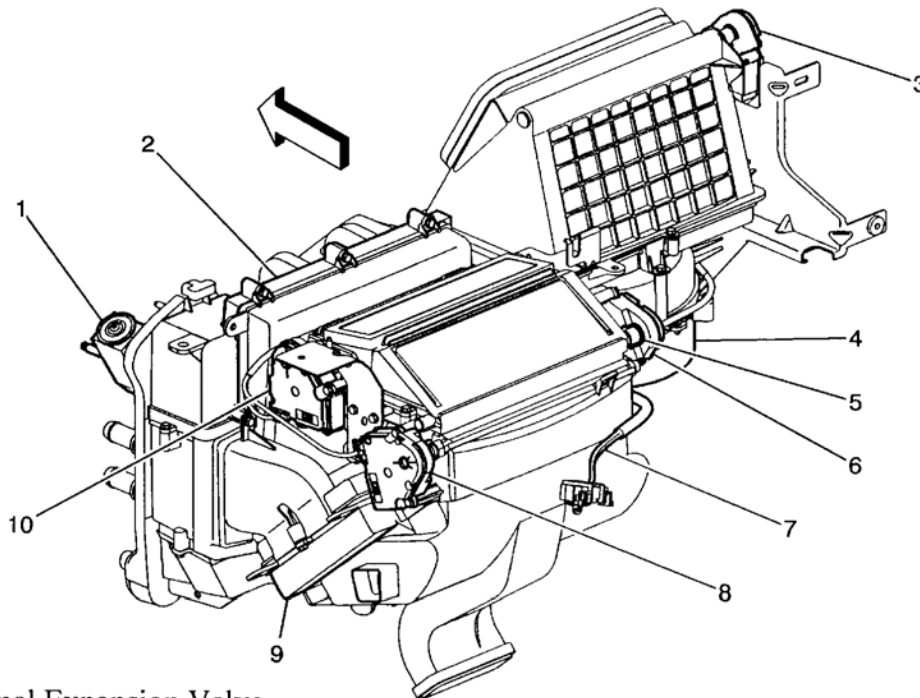

- (1) Thermal Expansion Valve
- (2) Evaporator
- (3) Recirculation Actuator
- (4) Blower Motor
- (5) Blower Motor Resistor
- (6) Mode Actuator - Panel
- (7) Temperature Cable
- (8) Mode Actuator - Defrost
- (9) Heater Core
- (10) Mode Actuator - Floor

G00259164

Fig. 26: Left Side Of HVAC
Courtesy of GENERAL MOTORS CORP.

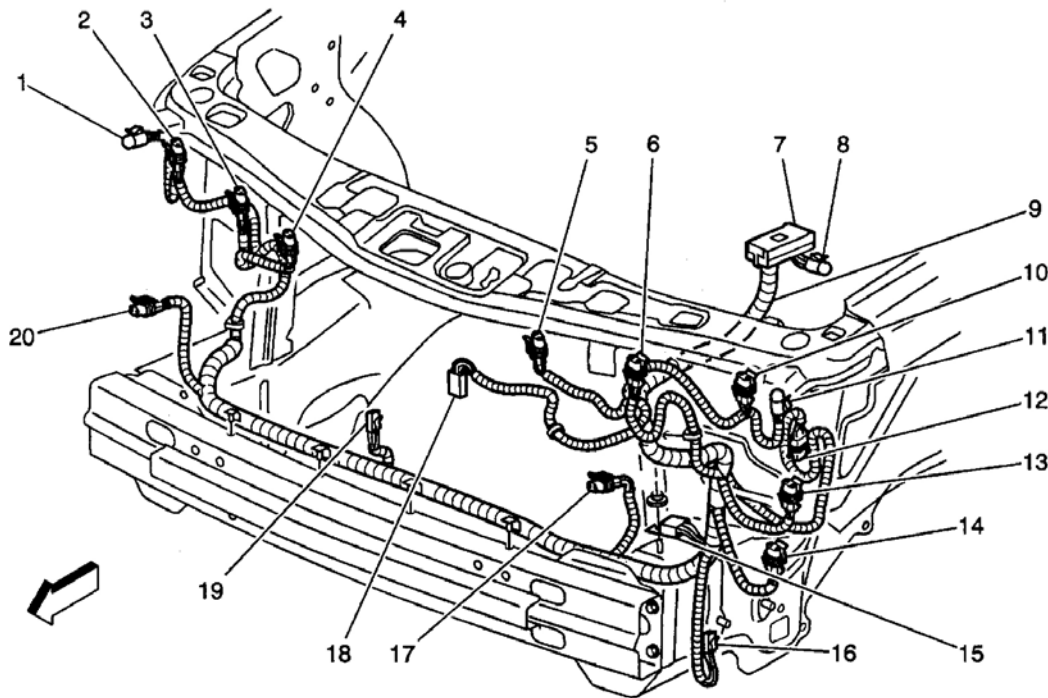

- (1) Marker Lamp - RF (2 GY)
- (2) Park/Turn Signal Lamp - RF (3 GY)
- (3) Headlamp - Right Low Beam (2 BK)
- (4) Headlamp - Right High Beam (2 BK)
- (5) Headlamp - Left High Beam (2 BK)
- (6) Headlamp - Left Low Beam (2 BK)
- (7) Fuse Block - Underhood C1
- (8) C106
- (9) S111
- (10) Park/Turn Signal Lamp - LF (3 GY)
- (11) Marker Lamp - LF (2 GY)
- (12) Windshield Washer Fluid Pump (2 BK)
- (13) Horn (2 GY)
- (14) Cooling Fan Resistor (2 GY)
- (15) Splice Pack SP301, G101
- (16) Daytime Running Lamp (DRL) Resistor (2 BK)

G00258562

Fig. 27: Front Of Vehicle (1 Of 2) (2.2L)
Courtesy of GENERAL MOTORS CORP.

(17) Fog Lamp - Left (2 BK) (w/T96)

(18) Cooling Fan (3 TN)

(19) Ambient Air Temperature Sensor (2 L-GN) (w/HAA)

(20) Fog Lamp - Right (2 BK) (w/T96)

G00258563

Fig. 28: Front Of Vehicle (2 Of 2) (2.2L)

Courtesy of GENERAL MOTORS CORP.

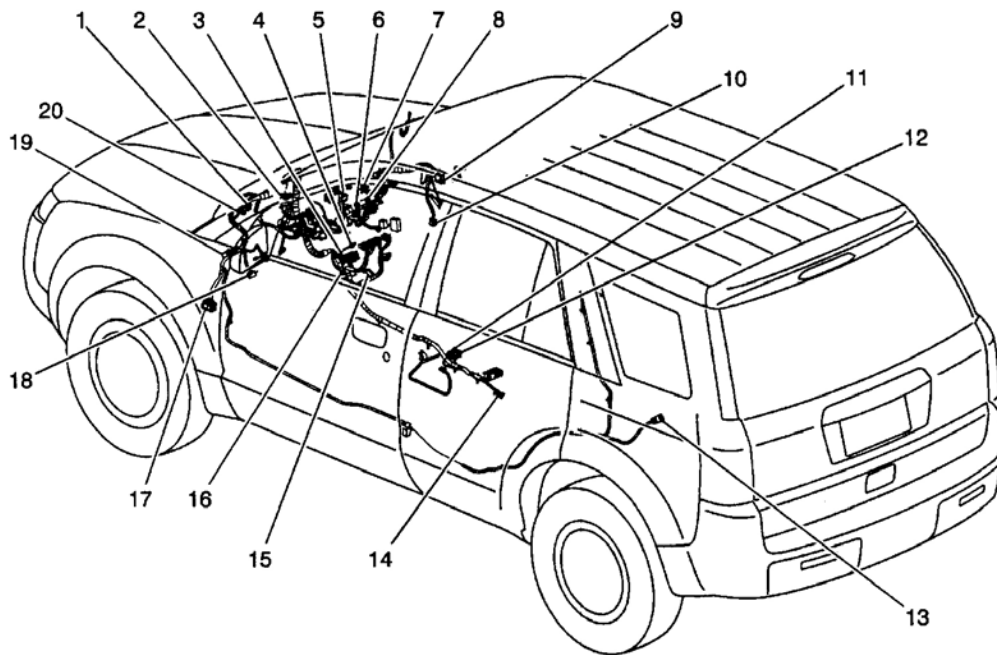

- (1) Inflatable Restraint Steering Wheel Module Coil C3
- (2) Instrument Panel Cluster (IPC)
- (3) I/P Fuse Block C2,C3
- (4) G203
- (5) C202 - HVAC Harness to the I/P Harness Connector
- (6) S201
- (7) C203 - I/P Harness to the Inflatable Restraint I/P Module Jumper Harness Connector
- (8) S205
- (9) Splice Pack SP201, G201
- (10) C311 - Body Harness to the I/P Harness Connector
- (11) C308 - SDM Harness to the SIS Harness Connector
- (12) C307 - Roof Rail Module Harness to the SDM Harness Connector
- (13) C303 - Headliner Harness to the I/P Harness Connector
- (14) C201 - Auxiliary Outlet Harness to the I/P Harness Connector
- (15) C204 - I/P Harness to the Digital Radio Harness Connector
- (16) S203

G00258564

Fig. 29: Instrument Panel Harness Routing (1 Of 2)
Courtesy of GENERAL MOTORS CORP.

- (17) C200 - I/P Harness to the Body Harness Connector
- (18) Data Link Connector (DLC)
- (19) Splice Pack SP203
- (20) Inflatable Restraint Steering Wheel Module Coil C5

G00258565

Fig. 30: Instrument Panel Harness Routing (2 Of 2)
Courtesy of GENERAL MOTORS CORP.

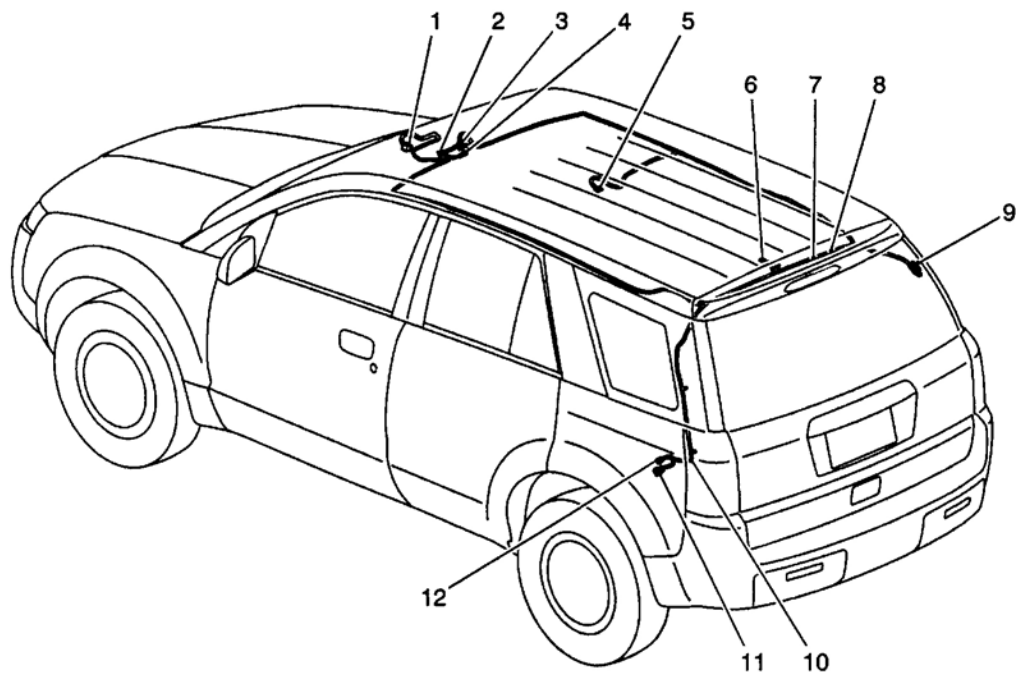

- (1) Inside Rearview Mirror (ISRM)
- (2) Courtesy/Map Lamps
- (3) Sunroof Switch
- (4) Cellular Telephone Microphone
- (5) Dome Lamp - Front
- (6) Dome Lamp - Rear
- (7) S302
- (8) S303
- (9) C302 - Sunroof Harness to Headliner Harness Connector
- (10) S301
- (11) C300 - Body Harness to Headliner Harness Connector
- (12) C303 - Headliner Harness to I/P Harness Connector

G00258566

Fig. 31: Roof
 Courtesy of GENERAL MOTORS CORP.

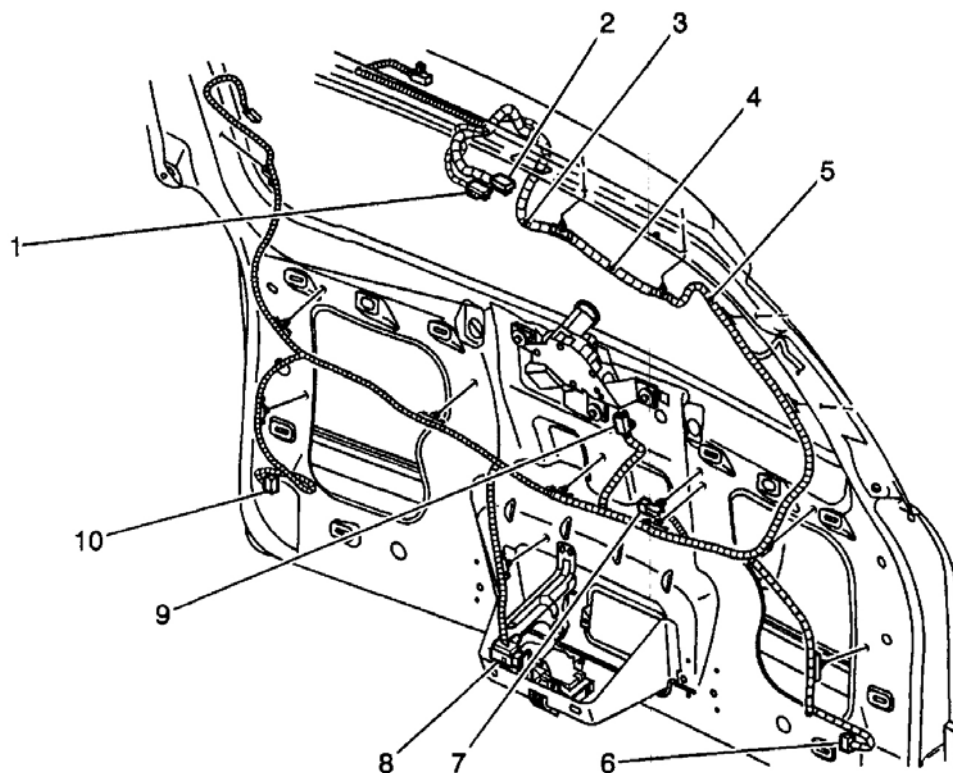

- (1) Body Harness to the Liftgate Harness Connector C403
- (2) Body Harness to the Liftgate Harness Connector C402
- (3) S402
- (4) S400
- (5) S407
- (6) Liftgate Lamp - Left
- (7) License Lamp Harness to the Liftgate Harness Connector C405
- (8) Liftgate Lock Actuator/Ajar Switch
- (9) Wiper Motor - Rear
- (10) Liftgate Lamp - Right

G00258567

Fig. 32: Liftgate
Courtesy of GENERAL MOTORS CORP.

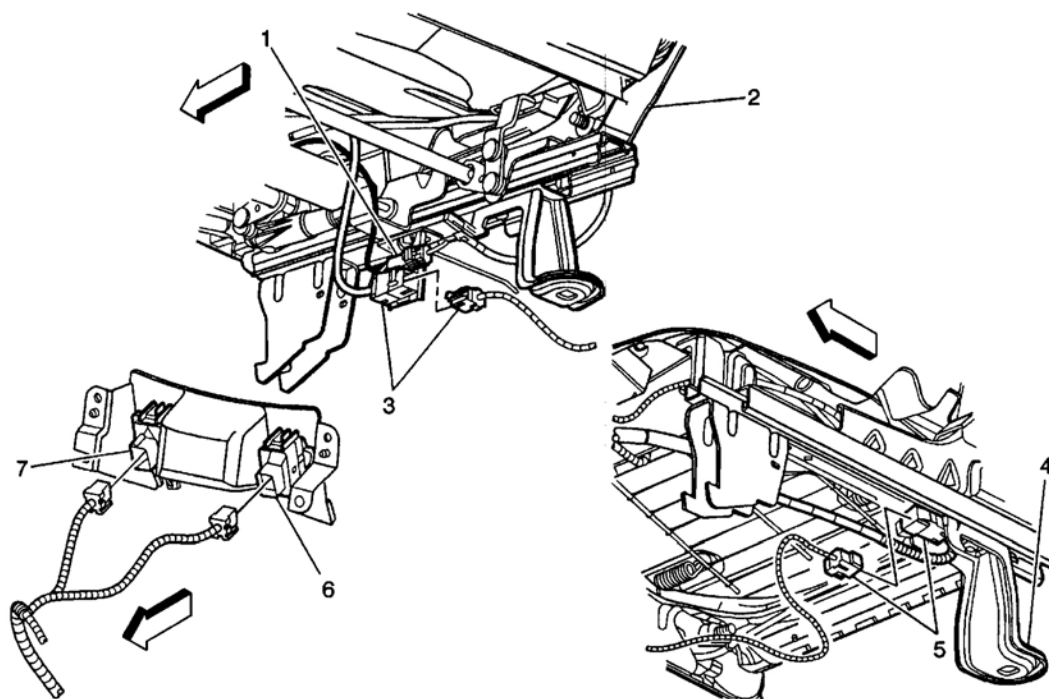

- (1) Not Used - Early Production
- (2) Seat - Driver
- (3) C305 - To the Driver Power/Heated Seat (w/ AG1,KA1)
- (4) Seat - Front Passenger
- (5) C306 - To the Front Passenger Heated Seat (w/ KA1)
- (6) Driver Heated Seat Switch (w/ KA1) (Mounted Near the Shifter Assembly)
- (7) Front Passenger Heated Seat Switch (w/ KA1) (Mounted Near the Shifter Assembly)

G00258568

Fig. 33: Bottom Of Driver/Passenger Seats
 Courtesy of GENERAL MOTORS CORP.

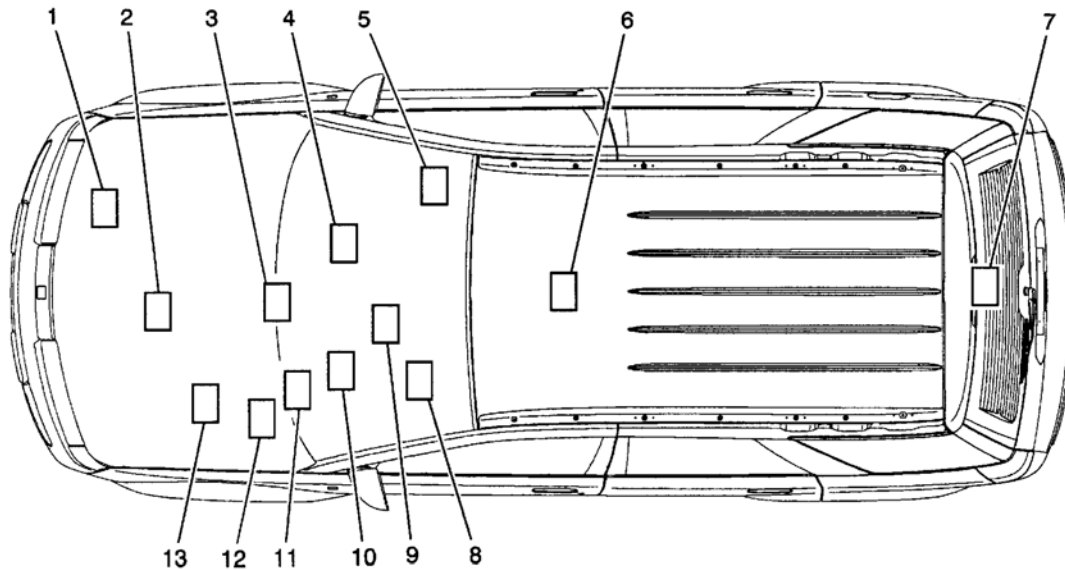

- (1) Engine Control Module (ECM) - L61
- (2) Engine Control Module (ECM) - L81
- (3) Power Steering Control Module (PSCM)
- (4) Body Control Module (BCM), Radio
- (5) Door Lock Switch and Actuator - Front Passenger, Rest Similar
- (6) Inflatable Restraint Sensing and Diagnostic Module (SDM)
- (7) Liftgate Lock Actuator/Ajar Switch
- (8) Data Link Connector (DLC)
- (9) Vehicle Communication Interface Module (VCIM)
- (10) Instrument Panel Cluster (IPC)
- (11) Passlock Sensor
- (12) Transmission Control Module (TCM)
- (13) Electronic Brake Control Module (EBCM)

G00258569

Fig. 34: Data Link Communications Component View
 Courtesy of GENERAL MOTORS CORP.